

# GEAR CHANGE MECHANISM

# CONTENTS

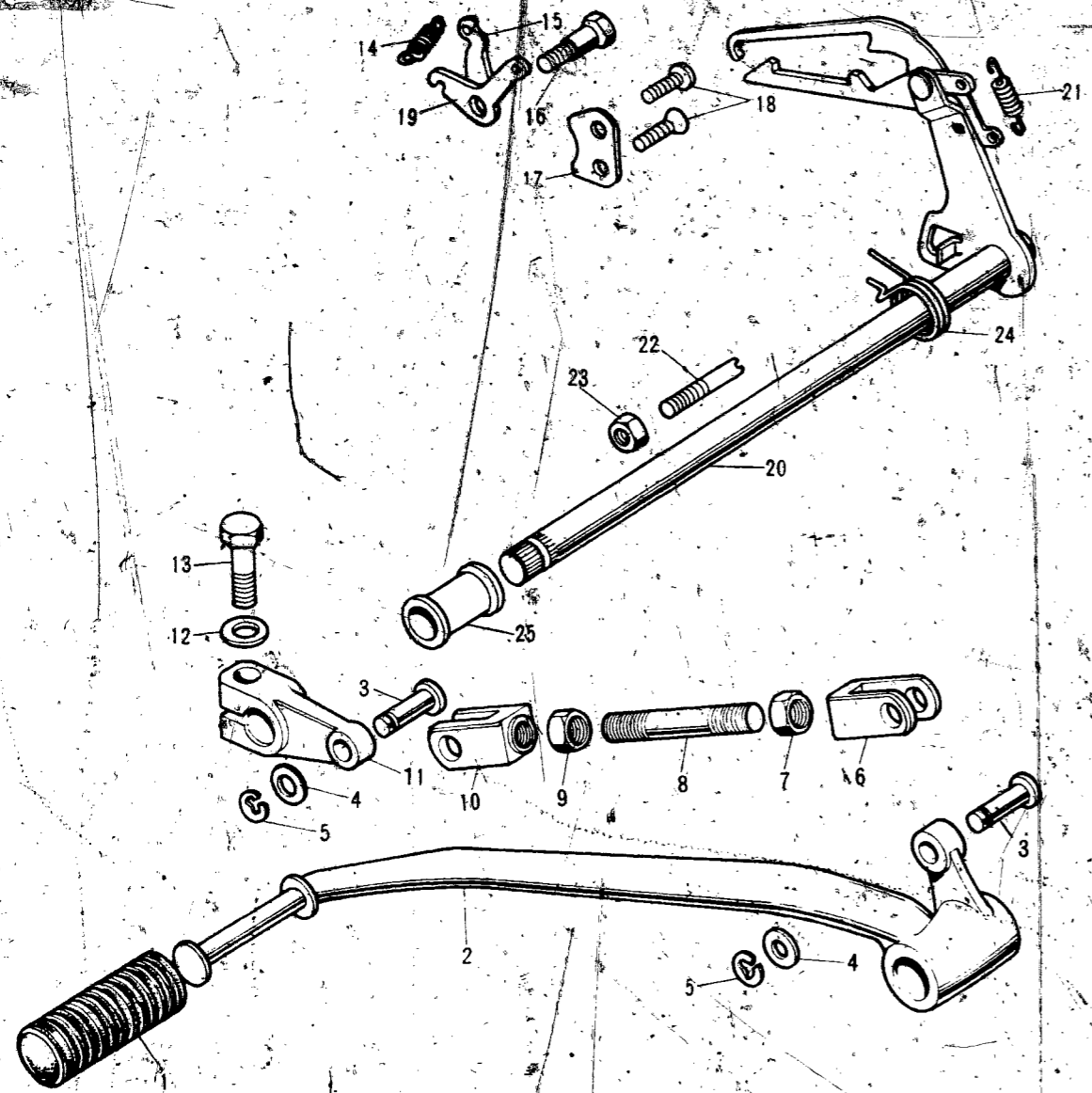

Ref. No.	Part No.	Part Name	Quantity	Remarks
1	13157-004	RUBBER-gear change pedal	1	
2	13156-040	PEDAL-gear change	1	
3	92043-069	PIN-joint	2	
4	410B0600	WASHER-plain, 6m/m	2	
5	482K5000	CIRCLIP, 5m/m	2	
6	13159-008	JOINT, (counterclock wise-thread)	1	
7	92017-010	NUT, 8m/m (counterclock wise-thread)	1	
8	92003-074	ROD	1	
9	318B0800	NUT, 8m/m	1	
10	13159-007	JOINT (clockwise-thread)	1	
11	13158-007	LEVER-gear change pedal	1	
12	401F0800	WASHER-spring, 8m/m	1	
13	110N0820	BOLT-hex head, 8x20	1	
14	92081-091	SPRING-gear change drum lever	1	
15	13170-005	LEVER-gear change drum	1	
16	92011-023	SCREW-gear change drum lever	1	
17	13169-007	PLATE-gear change drum position	1	
18	221B0616	SCREW-countersunk head, 6x16	2	
19	13236-002	Lever-gear change drum return	1	
20	13161-026	LEVER ASSY-gear change	1	
21	92081-011	SPRING-gear change lever	1	
22	92043-009	PIN-gear change pedal return spring	1	
23	312B0800	NUT, 8m/m	1	
24	92083-002	SPRING-gear change pedal return	1	
25	13171-004	DUST SHIELD-gear change shaft	1	

AIR CLEANER .....	B7
BRAKE DISC .....	E5
BRAKE DISC, EQUIPMENT .....	C7
CABLES .....	F4
CARBURETOR .....	C2
CLUTCH .....	A7
COVERS, ENGINE .....	B5
COVERS, SIDE .....	E7
CRANKCASE .....	A5
CRANKSHAFT .....	A6
CYLINDER, CYLINDER HEAD .....	A4
ELECTRICAL, ENGINE .....	B6
ELECTRICAL, WIRING .....	G3
FENDERS .....	D7
FOOTREST .....	C6
FORK, FRONT, S2 .....	D4
FORK, FRONT, S2-A .....	D5, D6
FRAME .....	C4
GEAR CHANGE MECHANISM .....	B3
HANDLEBAR .....	D2, D3
HEADLAMP, METERS, S2 .....	F5
HEADLAMP, METERS, S2-A .....	F6
HUB, FRONT, S2 .....	E4
HUB, FRONT, S2-A .....	E5
HUB, REAR .....	E3
KICKSTARTER .....	B4
MUFFLER .....	B7
OIL PUMP .....	C3
OPTIONAL PARTS .....	G4
PISTON, RINGS .....	A6
SEAT, DUAL, S2 .....	F2
SEAT, DUAL, S2-A .....	F3
SWINGARM .....	C5
TAIL LAMP, S2 .....	F7
TAIL LAMP, S2-A .....	G2
TANK, FUEL .....	E6
TANK, OIL .....	E7
TOOLS .....	G4
TRANSMISSION .....	B2
TURN SIGNAL, S2 .....	F7
TURN SIGNAL, S2-A .....	G2
WHEELS .....	E2