

KICKSTARTER MECHANISM

Ref. No.	Part No.	Part Name	Quantity	Remarks
1	13070-001	GUIDE-kick starter spring	1	
2	482J0100	CIRCLIP, 10m/m	2	
3	92081-021	SPRING-kick starter	1	
	13071-003	PLATE-kickstarter spring holder	1	
5	480J2600	CIRCLIP, 26m/m	1	
6	13077-002	HOLDER-kickstarter gear	1	
7	13068-024	GEAR-kickstarter	1	
8	13066-013	SHAFT-kickstarter	1	
	13245-003	SHAFT-kickstarter	1	
9	13072-006	STOPPER-kickstarter	1	
10	92028-072	BUSHING-kickstarter shaft	1	
11	480J1600	CIRCLIP, 16m/m	1	
12	13063-004	RUBBER-kickstarter pedal	1	
13-20	13058-038	PEDAL ASSY-kickstarter	1	
14	92043-068	PIN-kickstarter	1	
15	92081-020	SPRING-kickstarter pedal	1	
16	600A0800	STEEL BALL, 1/4"	1	
17	410B1000	WASHER-plain, 10m/m	1	
18	482J8000	CIRCLIP, 8m/m	1	
19	92001-101	BOLT-hex head, 10x25	1	
20	13061-015	BOSS-kickstarter pedal	1	

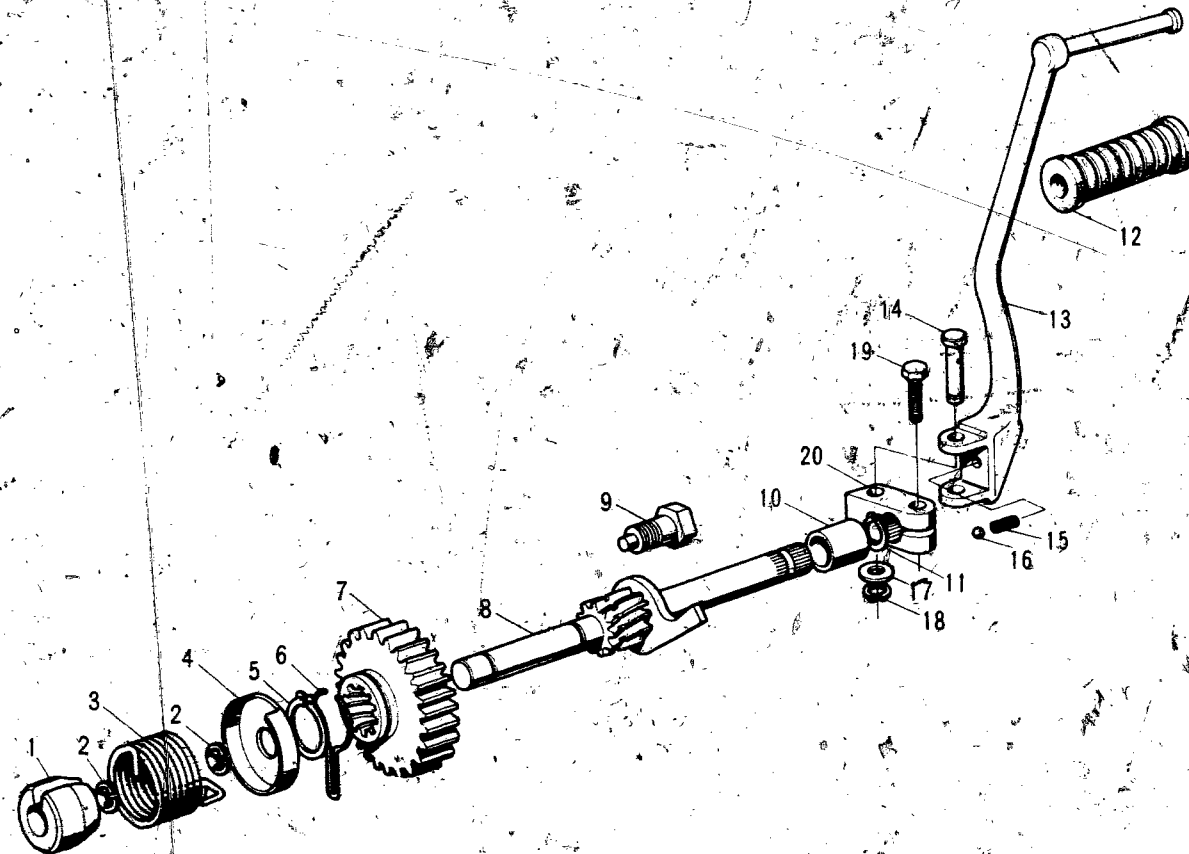

CONTENTS

AIR CLEANER	B7
BRAKE, DISC	E5
BRAKE DISC, EQUIPMENT	C7
CABLES	F4
CARBURETOR	C2
CLUTCH	A7
COVERS, ENGINE	B5
COVERS, SIDE	E7
CRANKCASE	A5
CRANKSHAFT	A6
CYLINDER, CYLINDER HEAD	A4
ELECTRICAL, ENGINE	B6
ELECTRICAL, WIRING	G3
FENDERS	D7
FOOTREST	C6
FORK, FRONT, S2	D4
FORK, FRONT, S2-A	D5, D6
FRAME	C4
GEAR CHANGE MECHANISM	B3
HANDLEBAR	D2, D3
HEADLAMP, METERS, S2	F5
HEADLAMP, METERS, S2-A	F6
HUB, FRONT, S2	E4
HUB, FRONT, S2-A	E5
HUB, REAR	E3
KICKSTARTER	B4
MUFFLER	B7
OIL PUMP	C3
OPTIONAL PARTS	G4
PISTON, RINGS	A6
SEAT, DUAL, S2	F2
SEAT, DUAL, S2-A	F3
SWINGARM	C5
TAIL LAMP, S2	F7
TAIL LAMP, S2-A	G2
TANK, FUEL	E6
TANK, OIL	E7
TOOLS	G4
TRANSMISSION	B2
TURN SIGNAL, S2	F7
TURN SIGNAL, S2-A	G2
WHEELS	E2