

ELECTRICAL, ENGINE

CONTENTS

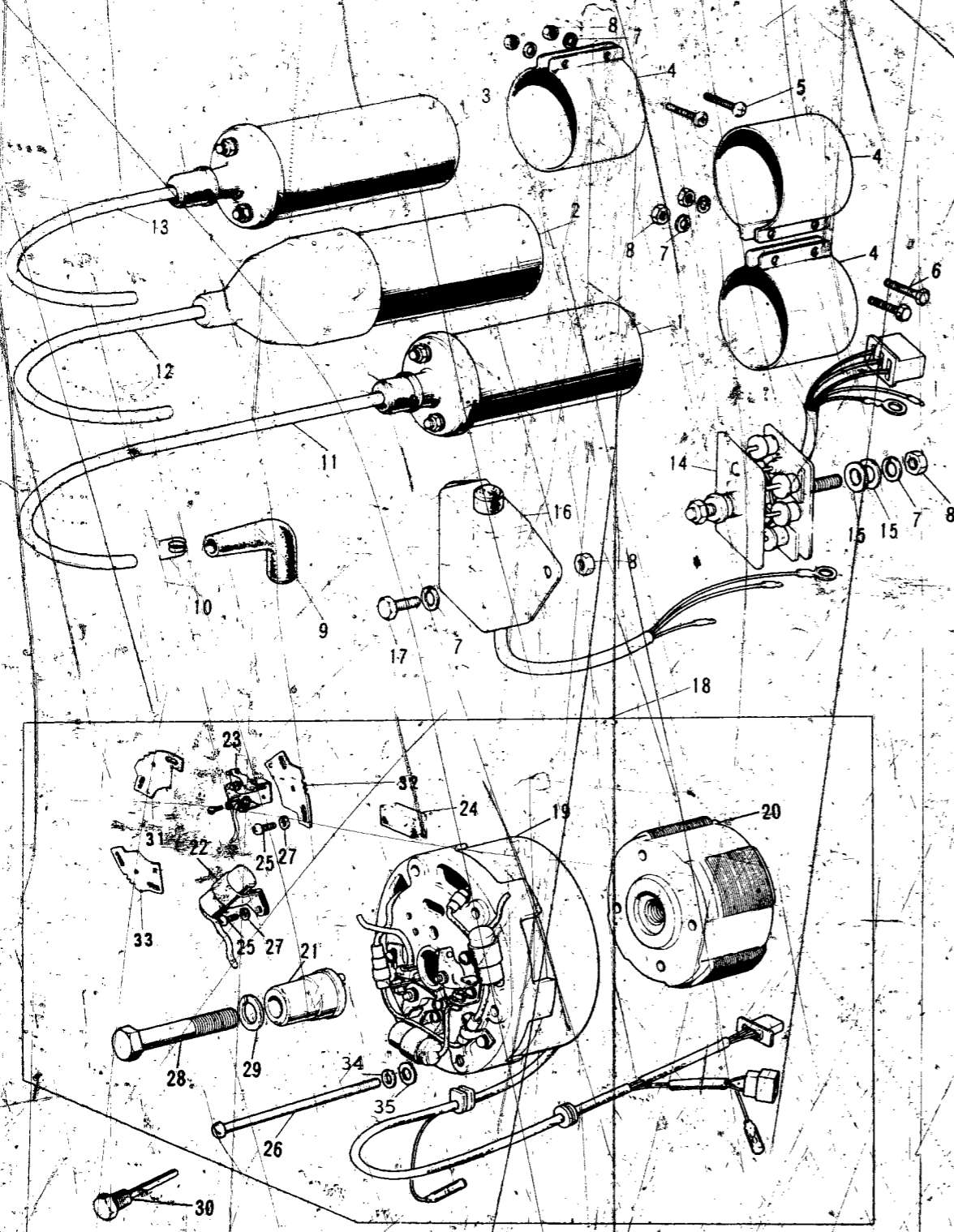

Ref. No.	Part No.	Part Name	Quantity	Remarks
1,4	21121-051	COIL-ignition, L.H.	1	
2,4	21121-052	COIL-ignition, CENTER	1	
3,4	21121-053	COIL-ignition, R.H.	1	
4	21126-004	BAND-ignition	3	
5	220B0640	SCREW-pan head, 6x40	2	
6	110B0616	BOLT-hex head, 6x16	2	
7	116B0616	BOLT-hex head, 6x16	ALT	
7	461F0600	WASHER-spring, 6m/m	7	
8	310B0800	NUT, 6m/m	7	
9	2N30-008	CAP-spark plug	3	
10	92401-001	SPRING-spark plug cap	3	
11	21133-020	CORD-high tension	1	
12	21133-021	CORD-high tension	1	
13	21133-022	CORD-high tension	1	
14	21061-011	RECTIFIER	1	
15	411B0600	WASHER-plain, 6m/m	4	
16	21066-012	REGULATOR (WHY NOT USE 21066-020)	1	
17	21066-020	REGULATOR	1	
17	110B0612	BOLT-hex head, 6x12	1	
18	116B0612	BOLT-hex head, 6x12	ALT	
18	21001-019	ALTERNATOR	1	
18	21001-022	ALTERNATOR	1 E/No 11111 & above	
19	21003-015	STATOR ASSY	1	
19	21003-016	STATOR ASSY	1 E/No. 11111 & above	
20	21007-020	ROTOR	1	
21	21014-008	CAM	1	
22	21013-026	CONDENSER	3	
23	21008-019	POINT-contact breaker	3	
24	21019-011	FELT-oil	2	
25	220B0408A	SCREW-pan head, 4x8	12	
26	21023-009	SCREW-pan head, 5x80	1	
27	220B0555A	SCREW-pan head, 5x55	3 E/No. 11111 & above	
27	461F0400	WASHER-spring, 4m/m	12	
28	114B0870	BOLT-hex head, 8x70	1	
29	461F0800	WASHER-spring, 8m/m	1	
30	56019-106	PULLER-rotor	as necessary	
31	21156-003	PLATE-contact breaker, L.H.	1	
32	21156-004	PLATE-contact breaker, CENTER	1	
33	21156-005	PLATE-contact breaker, R.H.	1	
34	461F0500	WASHER-spring, 5m/m	2 E/No. 11110 & below	
35	411B0500	WASHER-plain, 5m/m	2 E/No. 11110 and below	

AIR CLEANER	B7
BRAKE, DISC	E5
BRAKE DISC, EQUIPMENT	C7
CABLES	F4
CARBURETOR	C2
CLUTCH	A7
COVERS, ENGINE	B5
COVERS, SIDE	E7
CRANKCASE	A5
CRANKSHAFT	A6
CYLINDER, CYLINDER HEAD	A4
ELECTRICAL, ENGINE	B6
ELECTRICAL, WIRING	G3
FENDERS	D7
FOOTREST	C6
FORK, FRONT, S2	D4
FORK, FRONT, S2-A	D5, D6
FRAME	C4
GEAR CHANGE MECHANISM	B3
HANDLEBAR	D2, D3
HEADLAMP, METERS, S2	F5
HEADLAMP, METERS, S2-A	F6
HUB, FRONT, S2	E4
HUB, FRONT, S2-A	E5
HUB, REAR	E3
KICKSTARTER	B4
MUFFLER	B7
OIL PUMP	C3
OPTIONAL PARTS	G4
PISTON, RINGS	A6
SEAT, DUAL, S2	F2
SEAT, DUAL, S2-A	F3
SWINGARM	C5
TAIL LAMP, S2	F7
TAIL LAMP, S2-A	G2
TANK, FUEL	E6
TANK, OIL	E7
TOOLS	G4
TRANSMISSION	B2
TURN SIGNAL, S2	F7
TURN SIGNAL, S2-A	G2
WHEELS	E2

S2/S2-A

B6