

# FOOTREST, STANDS, REAR BRAKE PEDAL

# CONTENTS

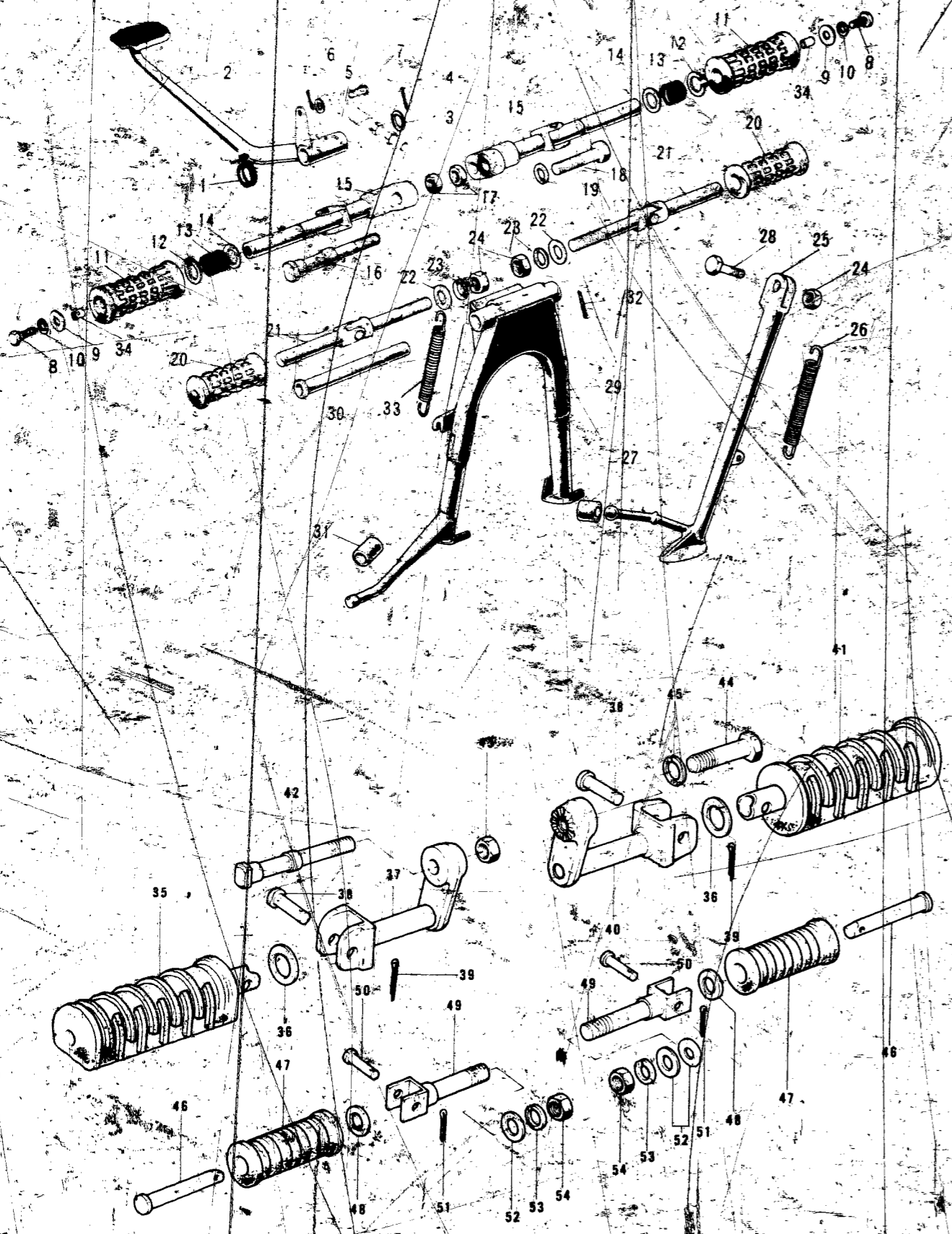

Ref. No.	Part No.	Part Name	Quantity	Remarks
1	43005-015	SPRING-brake pedal return	1	
2	43001-038	PEDAL-brake	1	
3	92022-085	WASHER-brake pedal fitting	1	
4	550D3020	COTTER PIN, 3.0x20	1	
5	410B0600	WASHER-plain, 6m/m	1	
6	550D2015	COTTER PIN, 2.0x15	1	
7	92043-034	PIN-brake cable joint	1	
8	110B0618	BOLT-hex head, 6x18	2	
9	116B0618	BOLT-hex head, 6x18	ALT	
9	92022-125	WASHER-plain, 6m/m	2	
10	461F0600	WASHER-spring, 6m/m	2	
11	92076-019	RUBBER FOOTREST	2	
12	480J1600	CIRCLIP, 16m/m	2	
13	34006-002	SPRING-footrest peg	2	
14	92022-049	WASHER-footrest peg	2	
15	34003-028	BAR-footrest	2	
16	92003-076	BOLT-change pedal	1	
17	315B1200A	NUT, 12m/m	2	
18	92007-025	BOLT-hex head, 12x40	1	
19	461F1200	WASHER-spring, 12m/m	1	
20, 21	34030-001	BAR SET-rear footrest	1	
20	92076-008	RUBBER-rear footrest	2	
21	34027-013	BAR-rear footrest	2	
22	410B1000	WASHER-plain, 10m/m	3	
23	461F1000	WASHER-spring, 10m/m	3	
24	313B1000	NUT, 10m/m	3	
25	34024-031	STAND-side	1	
26	34023-005	SPRING-side stand	1	
27	92075-031	RUBBER-side stand stopper	1	
28	113B1035	BOLT-hex head, 10x35	1	
29	34011-028	STAND-main	1	
30	34019-011	SHAFT-main stand	1	
31	92075-029	DAMPER RUBBER-main stand	1	
32	550D3025	COTTER PIN, 3.0x25	1	
33	34023-010	SPRING-main stand	1	
34	92027-103	COLLAR-footrest	2	
35	34028-011	BAR-footrest, L.H.	1	
36	92022-204	WASHER-plain	2	
37	34003-040	HOLDER-footrest bar, L.H.	1	
38	92043-080	PIN-footrest bar fitting	2	
39	550D2515	PIN-cotter, 2.5x15	2	
40	34003-041	HOLDER-footrest bar, R/H	1	
41	34028-012	BAR-footrest, R.H.	1	
42	92003-076	BOLT-L.H. footrest fitting	1	
43	315B1200A	NUT, 12m/m	1	
44	92007-025	BOLT-R.H. footrest fitting	1	
45	461F1200	WASHER-spring, 12m/m	1	
46	34028-010	BAR-rear footrest	2	
47	92076-020	RUBBER-rear footrest	2	
48	92022-199	WASHER-plain	2	
49	34029-008	BRACKET-rear footrest	2	
50	92043-079	PIN-rear footrest fitting	2	
51	550D2012	PIN-cotter, 2.0x12	2	
52	410B1000	WASHER-plain, 10m/m	3	
53	461F1000	WASHER-spring, 10m/m	2	
54	313B1000	NUT, 10m/m	2	

AIR CLEANER	B7
BRAKE DISC	E5
BRAKE DISC, EQUIPMENT	C7
CABLES	F4
CARBURETOR	C2
CLUTCH	A7
COVERS, ENGINE	B5
COVERS, SIDE	E7
CRANKCASE	A5
CRANKSHAFT	A6
CYLINDER, CYLINDER HEAD	A4
ELECTRICAL, ENGINE	B6
ELECTRICAL, WIRING	G3
FENDERS	D7
FOOTREST	C6
FORK, FRONT, S2	D4
FORK, FRONT, S2-A	D5, D6
FRAME	C4
GEAR CHANGE MECHANISM	B3
HANDLEBAR	D2, D3
HEADLAMP, METERS, S2	F5
HEADLAMP, METERS, S2-A	F6
HUB, FRONT, S2	E4
HUB, FRONT, S2-A	E5
HUB, REAR	E3
KICKSTARTER	B4
MUFFLER	B7
OIL PUMP	C3
OPTIONAL PARTS	G4
PISTON, RINGS	A6
SEAT, DUAL, S2	F2
SEAT, DUAL, S2-A	F3
SWINGARM	C5
TAIL LAMP, S2	F7
TAIL LAMP, S2-A	G2
TANK, FUEL	E6
TANK, OIL	E7
TOOLS	G4
TRANSMISSION	B2
TURN SIGNAL, S2	F7
TURN SIGNAL, S2-A	G2
WHEELS	E2

S2/S2-A

C6