

HANDLEBAR, GRIPS

CONTENTS

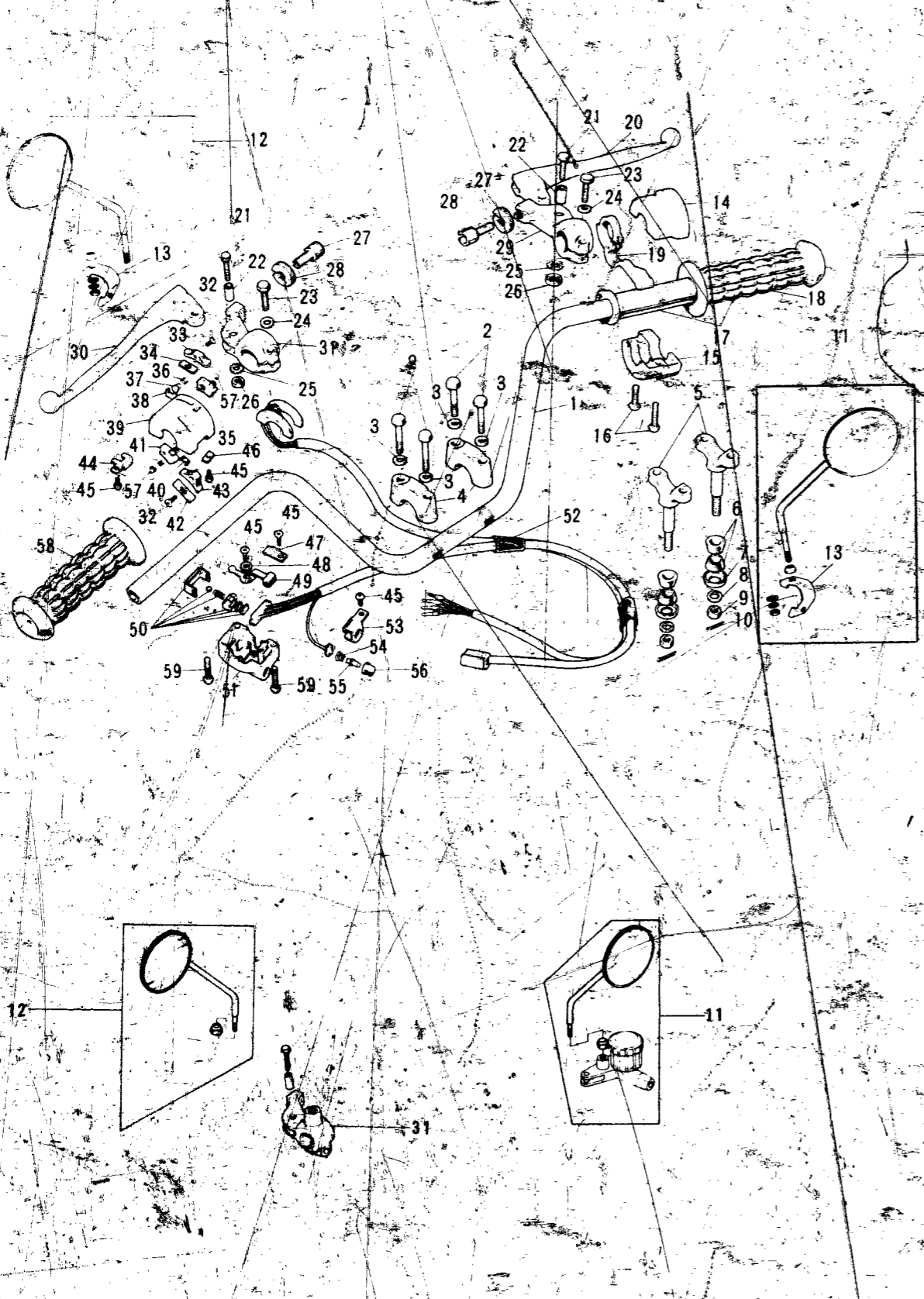

Ref. No.	Part No.	Part Name	Quantity	Remarks
1	46003-025	HANDLE BAR	1	
	46003-030	HANDLEBAR	1	S2-A
2	92007-002	BOLT-handlebar fitting	4	
3	461F0800	WASHER-spring, 8m/m	4	
4	46012-008	HOLDER-handlebar	2	
5	46012-010	HOLDER-handlebar	2	
6	92075-039	DAMPER RUBBER-handlebar	4	
7	46016-003	CAP-handlebar holder	2	
8	461F1000	WASHER-plain, 10m/m	2	
9	313B1000	NUT, 10m/m	2	
10	92041-005	COTTER PIN, 2.5x20	2	
11	56001-005	REAR VIEW MIRROR, R.H. Selective use	1	
	56002-020	REAR VIEW MIRROR, R.H. Option	1	S2-A
12	56003-007	REAR VIEW MIRROR, L.H. Selective use	1	
	56003-009	REAR VIEW MIRROR, L.H.	1	S2-A
13	56006-001	BRACKET-rear view mirror	2	
14-19	46018-018	CASE ASSY, R.H.	1	
14	46041-006	CASE-R.H. upper	1	
15	46023-006	CASE-R.H. lower	1	
16	220B0522A	SCREW-pad head, 5x22	2	
17	46019-017	GRIP ASSY-throttle	1	
	46019-023	GRIP ASSY-throttle	1	S2-A
18	46961-012	RUBBER-R.H. grip	1	
19	46096-007	LEVER-starter	1	
20-29	46021-013	LEVER ASSY-front brake	1	
20	46058-004	LEVER-front brake	1	
	46058-014	LEVER-front brake	1	option
21	92007-020	BOLT-hex head, 5x20	2	
22	46059-011	COLLAR-lever	2	
23	110N0622	BOLT-hex head, 6x22	2	
	110N0625	BOLT-hex head, 6x25	1	S2-A
24	410B0600	WASHER-plain, 6m/m	2	
25	464H0500	WASHER-lock, 5m/m	2	
26	312B0500A	NUT, 5m/m	2	
27	46056-005	NUT-cable adjuster lock	2	
28	46055-006	SCREW-cable adjuster	2	
29	46060-006	HOLDER-front, brake	1	

AIR CLEANER	B7
BRAKE, DISC	E5
BRAKE DISC, EQUIPMENT	C7
CABLES	F4
CARBURETOR	C2
CLUTCH	A7
COVERS, ENGINE	B5
COVERS, SIDE	E7
CRANKCASE	A5
CRANKSHAFT	A6
CYLINDER, CYLINDER HEAD	A4
ELECTRICAL, ENGINE	B6
ELECTRICAL, WIRING	G3
FENDERS	D7
FOOTREST	C6
FORK, FRONT, S2	D4
FORK, FRONT, S2-A	D5, D6
FRAME	C4
GEAR CHANGE MECHANISM	B3
HANDLEBAR	D2, D3
HEADLAMP, METERS, S2	F5
HEADLAMP, METERS, S2-A	F6
HUB, FRONT, S2	E4
HUB, FRONT, S2-A	E5
HUB, REAR	E3
KICKSTARTER	B4
MUFFLER	B7
OIL PUMP	C3
OPTIONAL PARTS	G4
PISTON, RINGS	A6
SEAT, DUAL, S2	F2
SEAT, DUAL, S2-A	F3
SWINGARM	C5
TAIL LAMP, S2	F7
TAIL LAMP, S2-A	G2
TANK, FUEL	E6
TANK, OIL	E7
TOOLS	G4
TRANSMISSION	B2
TURN SIGNAL, S2	F7
TURN SIGNAL, S2-A	G2
WHEELS	E2

S2/S2-A

D2