

REAR HUB

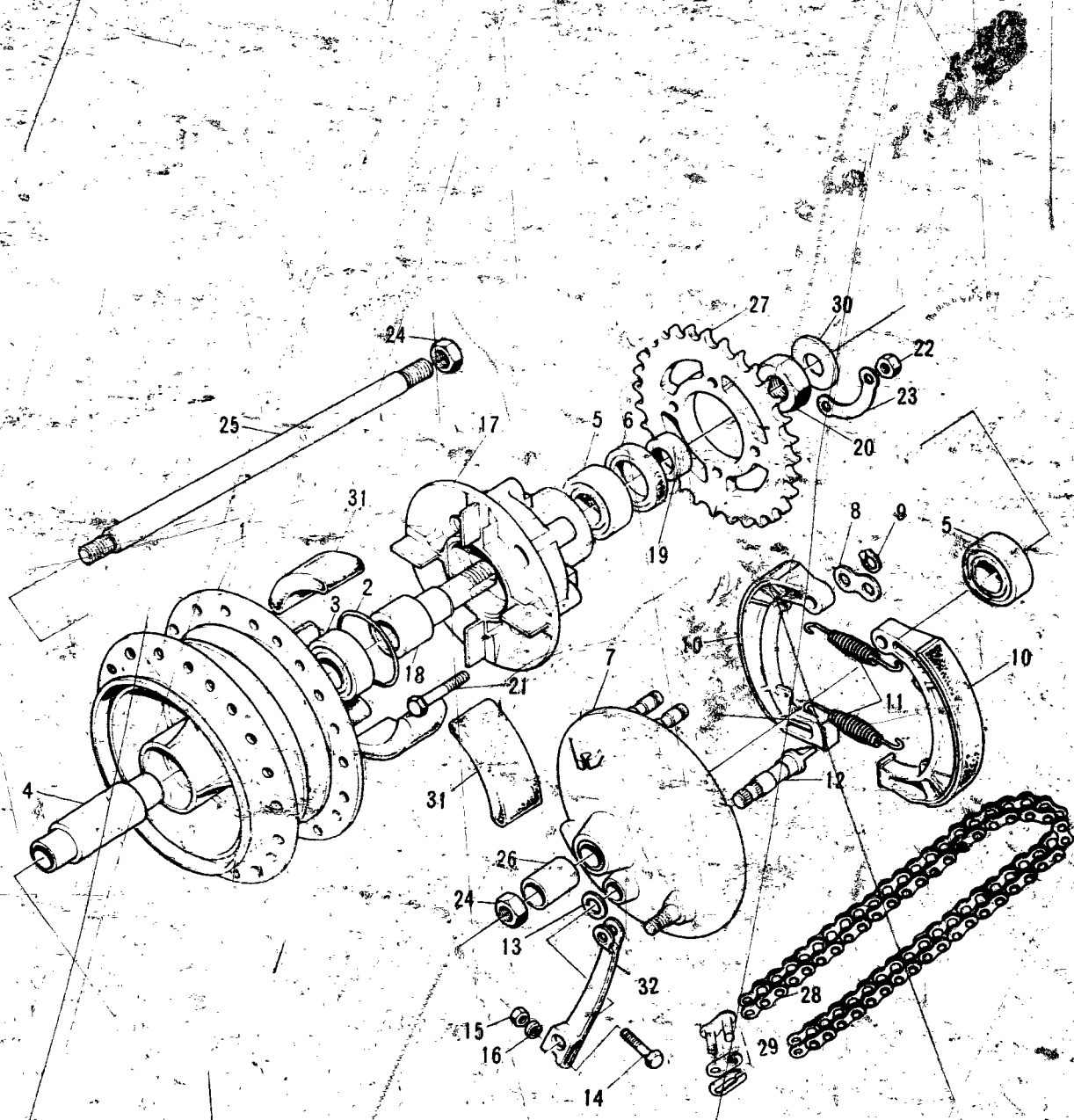

Ref. No.	Part No.	Part Name	Quantity	Remarks
1~6	42005-009	DRUM ASSY-rear brake	1	
2	671B2560	"O" RING, 60m/m	1	
3	601B6205	BALL BEARING, #. 6205	2	
4	42010-008	SPACER-rear hub bearing	1	✓
5	601B6205Z	BALL BEARING, #. 6205Z	1	
6	92052-006	OIL SEAL, PJX135527	1	
7~16, 32	42006-007-21	PANEL ASSY-rear brake, flat black	1	
	42006-007-80	PANEL ASSY-rear brake, Buff Finish	1	S2-A
8	41045-001	WASHER-brake shoe pin	1	
9	480J1460	CIRCLIP, 14m/m	2	
10	42019-003	SHOE-rear brake	2	
11	41049-003	SPRING-brake shoe	2	
12	42026-004	CAM SHAFT-rear brake	1	
13	41051-001	DUST SHIELD-brake cam shaft	1	
14	110B0640	BOLT-hex head, 6x40	1	
	116B0640	BOLT-hex head, 6x40	ALT	
15	310B0600	NUT, 6m/m	1	
16	410B0600	WASHER-plain, 6m/m	1	
17~23, 31	42008-002	COUPLING ASSY-rear hub(use 42008-012)	1	
	42008-012	COUPLING ASSY-rear hub	1	
18	42036-006	SLEEVE-rear axle	1	
19	42037-006	COLLAR-rear axle sleeve	1	
20	42045-006	NUT-sleeve	1	
21	92003-015	BOLT-rear sprocket fitting WHN EXH USE 92003-087	4	
	93003-087	BOLT-rear sprocket fitting	4	
22	313B1000	NUT, 10m/m	4	
23	92088-005	WASHER-sprocket lock	2	
24	313B1600	NUT, 16m/m 1 ea not required for 42031-033	2	
25	42031-024	AXLE-rear WHN EXH USE 42031-033	1	
	42031-033	AXLE-rear	1	S2-A
26	42032-008	COLLAR-R.H. rear hub collar	1	
27	42041-102	REAR SPROCKET, 43T	1	
28, 29	92057-014	CHAIN ASSY-drive, EK530SH	1	
29	92058-008	JOINT ASSY-drive chain	1	
30	42046-009	WASHER-sleeve	1	
31	42014-008	SHOCKDAMER-rear hub	4	
32	42029-006	LEVER-rear brake cam	1	

CONTENTS

AIR CLEANER	B7
BRAKE, DISC	E5
BRAKE DISC, EQUIPMENT	C7
CABLES	F4
CARBURETOR	C2
CLUTCH	A7
COVERS, ENGINE	B5
COVERS, SIDE	E7
CRANKCASE	A5
CRANKSHAFT	A6
CYLINDER, CYLINDER HEAD	A4
ELECTRICAL, ENGINE	B6
ELECTRICAL, WIRING	G3
FENDERS	B7
FOOTREST	C6
FORK, FRONT, S2	D4
FORK, FRONT, S2-A	D5, D6
FRAME	C4
GEAR CHANGE MECHANISM	B3
HANDLEBAR	D2, D3
HEADLAMP, METERS, S2	F5
HEADLAMP, METERS, S2-A	F6
HUB, FRONT, S2	E4
HUB, FRONT, S2-A	E5
HUB, REAR	E3
KICKSTARTER	B4
MUFFLER	B7
OIL PUMP	C3
OPTIONAL PARTS	G4
PISTON, RINGS	A6
SEAT, DUAL, S2	F2
SEAT, DUAL, S2-A	F3
SWINGARM	C5
TAIL LAMP, S2	F7
TAIL LAMP, S2-A	G2
TANK, FUEL	E6
TANK, OIL	E7
TOOLS	G4
TRANSMISSION	B2
TURN SIGNAL, S2	F7
TURN SIGNAL, S2-A	G2
WHEELS	E2

S2/S2-A