

OIL TANK, SIDE COVERS, CHAIN COVER

CONTENTS

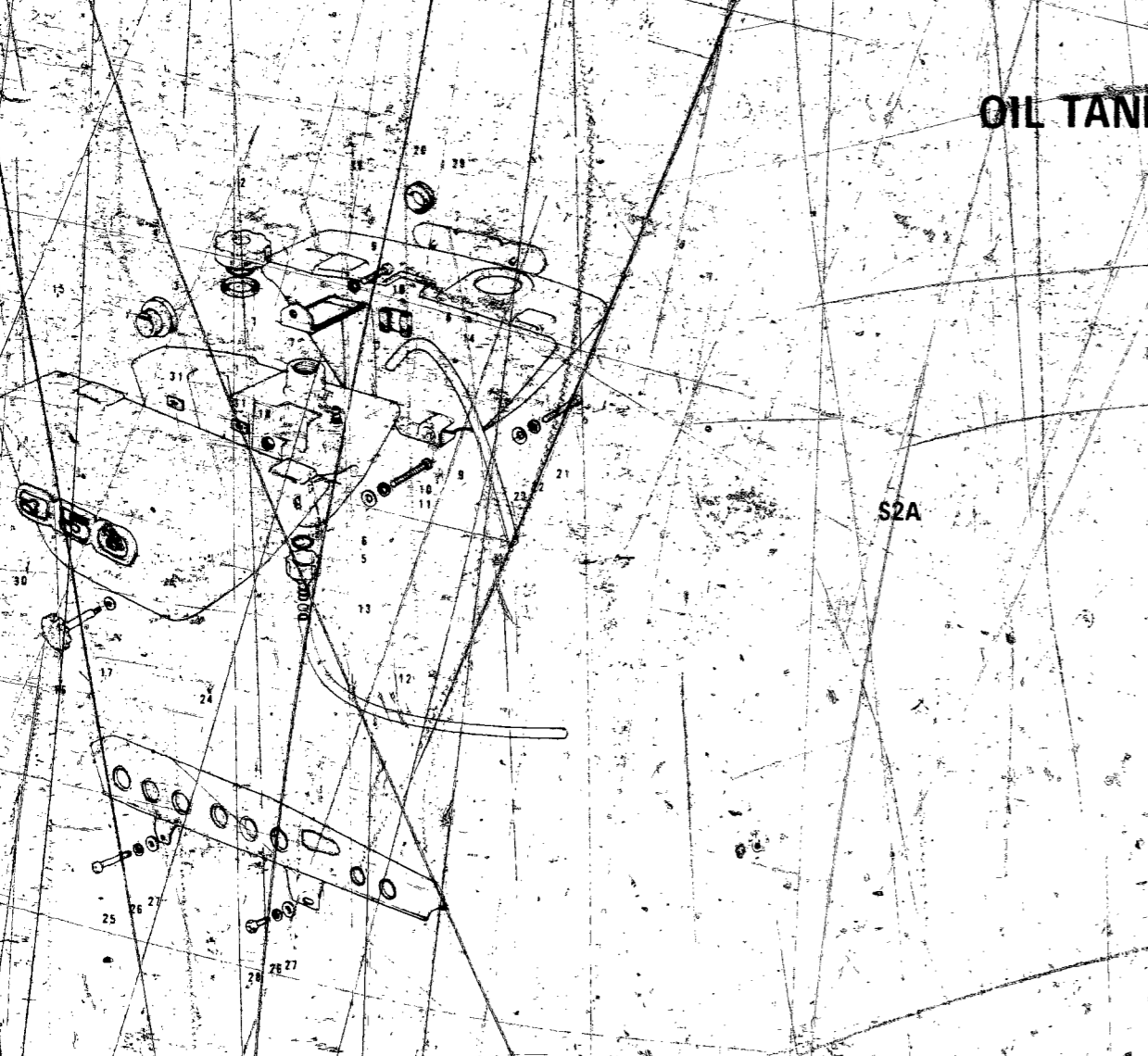

S2A

Ref. No.	Part No.	Part Name	Quantity	Remarks
1	52001-033	TANK oil	1	
2	52003-020	CAP-oil tank	1	
3	92065-086	GASKET-oil tank cap	1	
4	52015-005	GAUGE-oil level	1	
5	52020-001	FILTER-oil	1	
6	670B2015	"O" RING, 15 m/m	1	
7	52018-002	BAND-oil tank	1	
8	31082-010	DAMPER RUBBER-oil tank band	2	
9	220E0614	SCREW-pan head, 6 x 14	2	
10	461F0600	WASHER-spring, 6 m/m	2	
11	411B0600	WASHER-plain, 6 m/m	1	
12	92059-072	PIPE-oil	1	
13	92037-010	CLAMP	2	
14	700Q05600	TUBE-vinyl, 5 x 600	1	
15	36001-039-91	COVER-L. H. side, '72 Candytone Orange	1	
	36001-039-93	COVER-L. H. side, '72 Candytone Blue	1	
16	92077-020	KNOB-side cover	1	
17	92075-041	DAMPER RUBBER-side cover	1	
18	312B0600	NUT, 6 m/m	1	
19	36007-031-91	COVER-R. H. side, '72 Candytone Orange	1	
	36007-031-93	COVER-R. H. side, '72 Candytone Blue	1	
20	92071-065	GROMMET-side cover	1	
21	220E0635	SCREW-pan head, 6 x 35	1	
22	461F0600	WASHER-spring, 6 m/m	1	
23	411D0600	WASHER-plain, 6 m/m	1	
24	36014-040-21	COVER-chain, flat black	1	
25	220E0655	SCREW-pan head, 6 x 55	1	
26	461F0600	WASHER-spring, 6 m/m	2	
27	92022-193	WASHER-plain	2	
28	92001-121	BOLT-hex head, 6 x 14	1	
29	56018-135	EMBLEM-R. H. side cover	1	
30	56018-136	EMBLEM-L. H. side cover	1	
31	92018-003	NUT-lock	4	

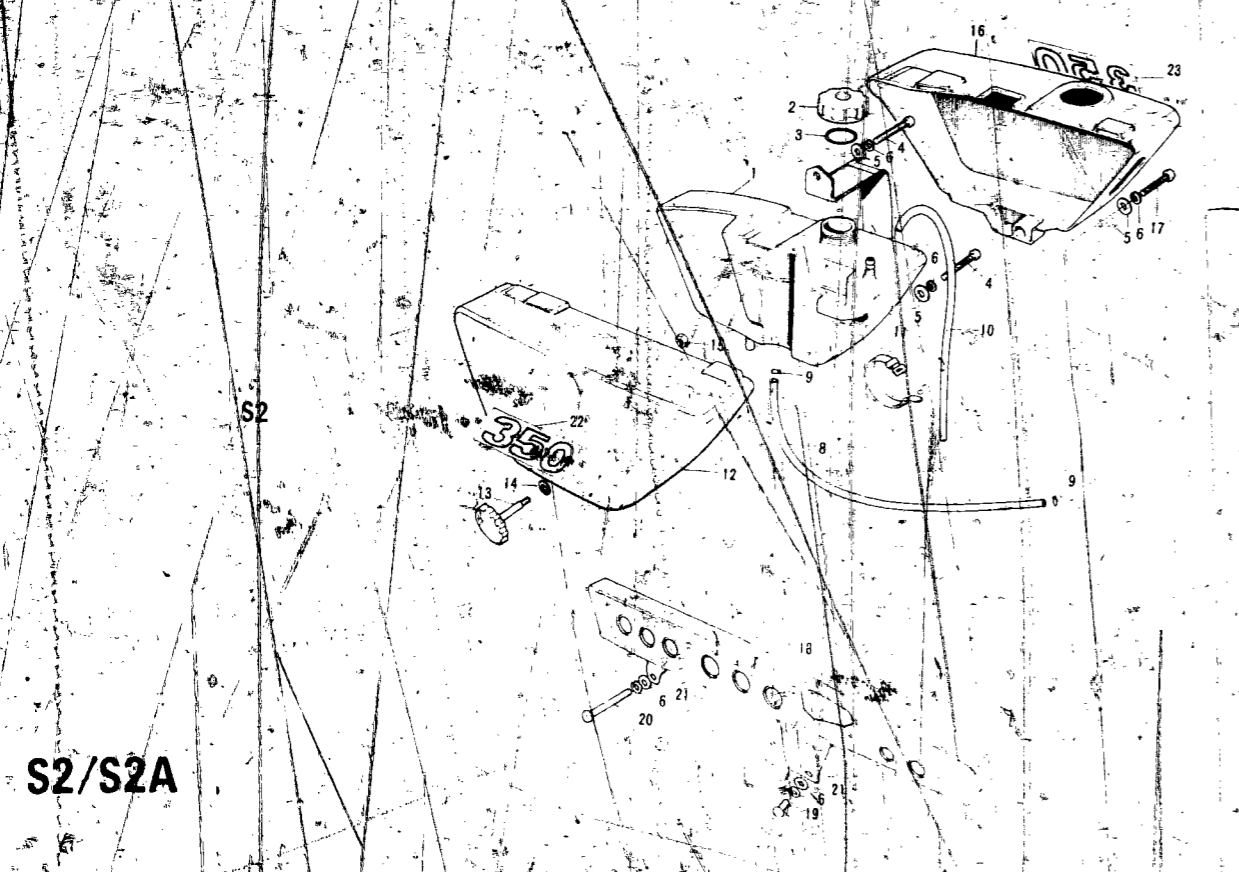

S2/S2A

Ref. No.	Part No.	Part Name	Quantity	Remarks
1	52001-025	TANK-oil	1	
2	52003-015	CAP-oil tank	1	
3	92065-020	GASKET-oil tank cap	1	
4	220B0612	SCREW-pan head, 6 x 12	2	
5	411B0600	WASHER-plain, 6 m/m	3	
6	461F0600	WASHER-spring, 6 m/m	3	
7	52018-002	BAND-oil tank	1	
8	92059-072	PIPE-oil	1	
9	92037-010	CLAMP-fuel pipe	2	
10	700Q05600	TUBE-vinyl, 5 x 600	1	
11	92072-030	BAND, short	2	
12	36001-031-68	COVER-L. H. side, pearl candytone red	1	
13	92077-020	KNOB-side cover	1	
14	92075-041	DAMPER RUBBER-side cover	1	
15	312B0600	NUT, 6 m/m	1	
16	36007-026-68	COVER-R. H. side, pearl candytone red	1	
17	220E0635	SCREW-pan head, 6 x 35	1	
18	36014-040-21	COVER-chain	1	
19	220E0612	SCREW-pan head, 6 x 12	1	
20	220E0655	SCREW-pan head, 6 x 55	1	
21	92022-165	WASHER-plain, 6 m/m	2	
22	56018-084	EMBLEM-L. H. side cover	1	for pearl candytone
23	56018-086	EMBLEM-R. H. side cover	1	red

AIR CLEANER	B7
BRAKE DISC	E5
BRAKE DISC EQUIPMENT	C7
CABLES	F4
CARBURETOR	C2
CLUTCH	A7
COVERS, ENGINE	B5
COVERS, SIDE	E7
CRANKCASE	A5
CRANKSHAFT	A6
CYLINDER, CYLINDER HEAD	A4
ELECTRICAL, ENGINE	B6
ELECTRICAL WIRING	G3
FENDERS	D7
FOOTREST	C6
FORK, FRONT, S2	D4
FORK, FRONT, S2-A	D5, D6
FRAME	C4
GEAR CHANGE MECHANISM	B3
HANDLEBAR	D2, D3
HEADLAMP, METERS, S2	F5
HEADLAMP, METERS, S2-A	F6
HUB, FRONT, S2	E4
HUB, FRONT, S2-A	E5
HUB, REAR	E3
KICKSTARTER	B4
MUFFLER	B7
OIL PUMP	C3
OPTIONAL PARTS	G4
PISTON, RINGS	A6
SEAT, DUAL, S2	F2
SEAT, DUAL, S2-A	F3
SWINGARM	C5
TAIL LAMP, S2	F7
TAIL LAMP, S2-A	G2
TANK, FUEL	E6
TANK, OIL	E7
TOOLS	G4
TRANSMISSION	B2
TURN SIGNAL, S2	F7
TURN SIGNAL, S2-A	G2
WHEELS	E2