

DUAL SEAT, SEAT BACKREST S2-A

CONTENTS

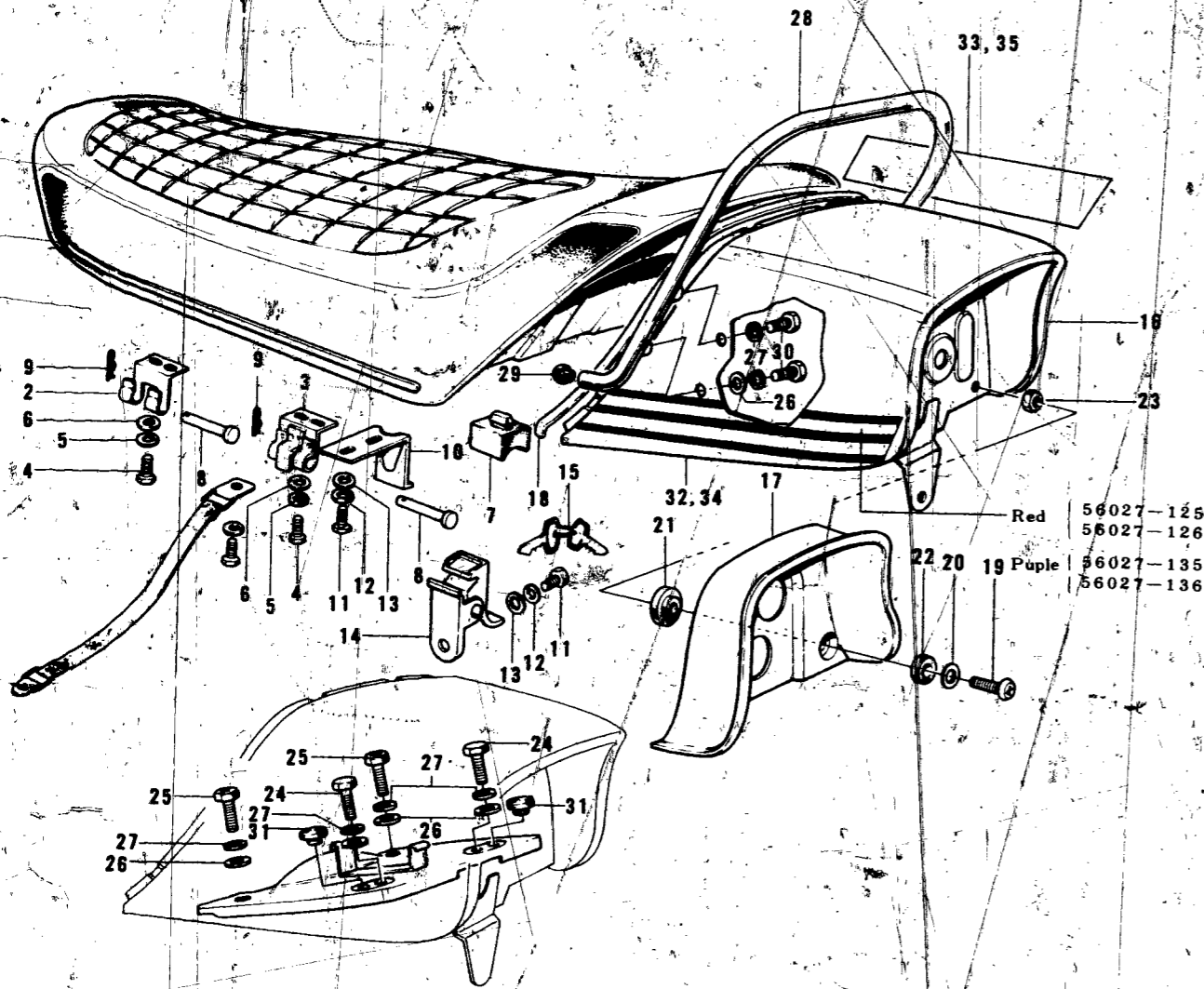

Ref. No.	Part No.	Part Name	Quantity	Remarks
1-7	53001-078	SEAT ASSY-dual	1	
2	53009-017	HINGE A	1	
3	53009-021	HINGE B	1	
4	110B0614	BOLT-hex head, 6 x 14	4	
	116B0614	BOLT-hex head, 6 x 14	ALT	
5	461F0600	WASHER-spring, 6 m/m	4	
6	411B0600	WASHER-plain, 6 m/m	4	
7	92075-156	DAMPER RUBBER-dual seat	5	
8	53011-002	PIN-dual seat pivot	2	
9	92041-003	COTTER PIN	2	
10	53008-011	HOOK	1	
11	110B0614	BOLT-hex head, 6 x 14	3	
	116B0614	BOLT-hex head, 6 x 14	ALT	
12	461F0600	WASHER-spring, 6 m/m	3	
13	411B0600	WASHER-plain, 6 m/m	3	
14, 15	53045-003	HOOK ASSY	1	
	27018-016-65	KEY SET. #265	27018-016-73	KEY SET. #273
	27018-016-66	KEY SET. #266	27018-016-74	KEY SET. #274
	27018-016-67	KEY SET. #267	27018-016-75	KEY SET. #275
	27018-016-68	KEY SET. #268	27018-016-76	KEY SET. #276
	27018-016-69	KEY SET. #269	27018-016-77	KEY SET. #277
	27018-016-70	KEY SET. #270	27018-016-78	KEY SET. #278
	27018-016-71	KEY SET. #271	27018-016-79	KEY SET. #279
	27018-016-72	KEY SET. #272		
16	53043-005-91	BACK REST. '72 Candytone Orange	1	
	53043-005-93	BACK REST. '72 Candytone Blue	1	
17	53057-001	COVER-back rest	1	
18	53044-003	MOLE	1	
19	92011-030	SCREW-pan head, 6 x 30	4	
20	92022-240	WASHER-plain	4	
21	92075-169	DAMPER RUBBER B-back rest cover	4	
22	92075-168	DAMPER RUBBER A-back rest cover	4	
23	311B0600	NUT, 6 m/m	4	
24	110B0816	BOLT-hex head, 8 x 16	2	
25	92001-122	BOLT-hex head, 8 x 16	2	
26	411B0800	WASHER-plain, 8 m/m	6	
27	461F0800	WASHER-spring, 8 m/m	8	
28	53042-005	GRIP-seat	1	
29	32112-005	PLUG-seat grip	2	
30	110B0812	BOLT-hex head, 8 x 12	4	
31	92068-007	PLUG	2	
32	*56027-135	DECAL-back rest stripe, L. H.	1	use for '72 Candytone
33	*56027-136	DECAL-back rest stripe, R. H.	1	blue color
34	*56027-125	DECAL-back rest stripe, L. H.	1	use for '72 Candytone
35	*56027-126	DECAL-back rest stripe, R. H.	1	org color

AIR CLEANER	B7
BRAKE, DISC	E5
BRAKE DISC, EQUIPMENT	C7
CABLES	F4
CARBURETOR	C2
CLUTCH	A7
COVERS, ENGINE	B5
COVERS, SIDE	E7
CRANKCASE	A5
CRANKSHAFT	A6
CYLINDER, CYLINDER HEAD	A4
ELECTRICAL, ENGINE	B6
ELECTRICAL, WIRING	G3
FENDERS	D7
FOOTREST	C6
FORK, FRONT, S2	D4
FORK, FRONT, S2-A	D5, D6
FRAME	C4
GEAR CHANGE MECHANISM	B3
HANDLEBAR	D2, D3
HEADLAMP, METERS, S2	F5
HEADLAMP, METERS, S2-A	F6
HUB, FRONT, S2	E4
HUB, FRONT, S2-A	E5
HUB, REAR	E3
KICKSTARTER	B4
MUFFLER	B7
OIL PUMP	C3
OPTIONAL PARTS	G4
PISTON, RINGS	A6
SEAT, DUAL, S2	F2
SEAT, DUAL, S2-A	F3
SWINGARM	C5
TAIL LAMP, S2	F7
TAIL LAMP, S2-A	G2
TANK, FUEL	E6
TANK, OIL	E7
TOOLS	G4
TRANSMISSION	B2
TURN SIGNAL, S2	F7
TURN SIGNAL, S2-A	G2
WHEELS	E2

S2-A

F3