

# HEADLAMP/METERS

# CONTENTS

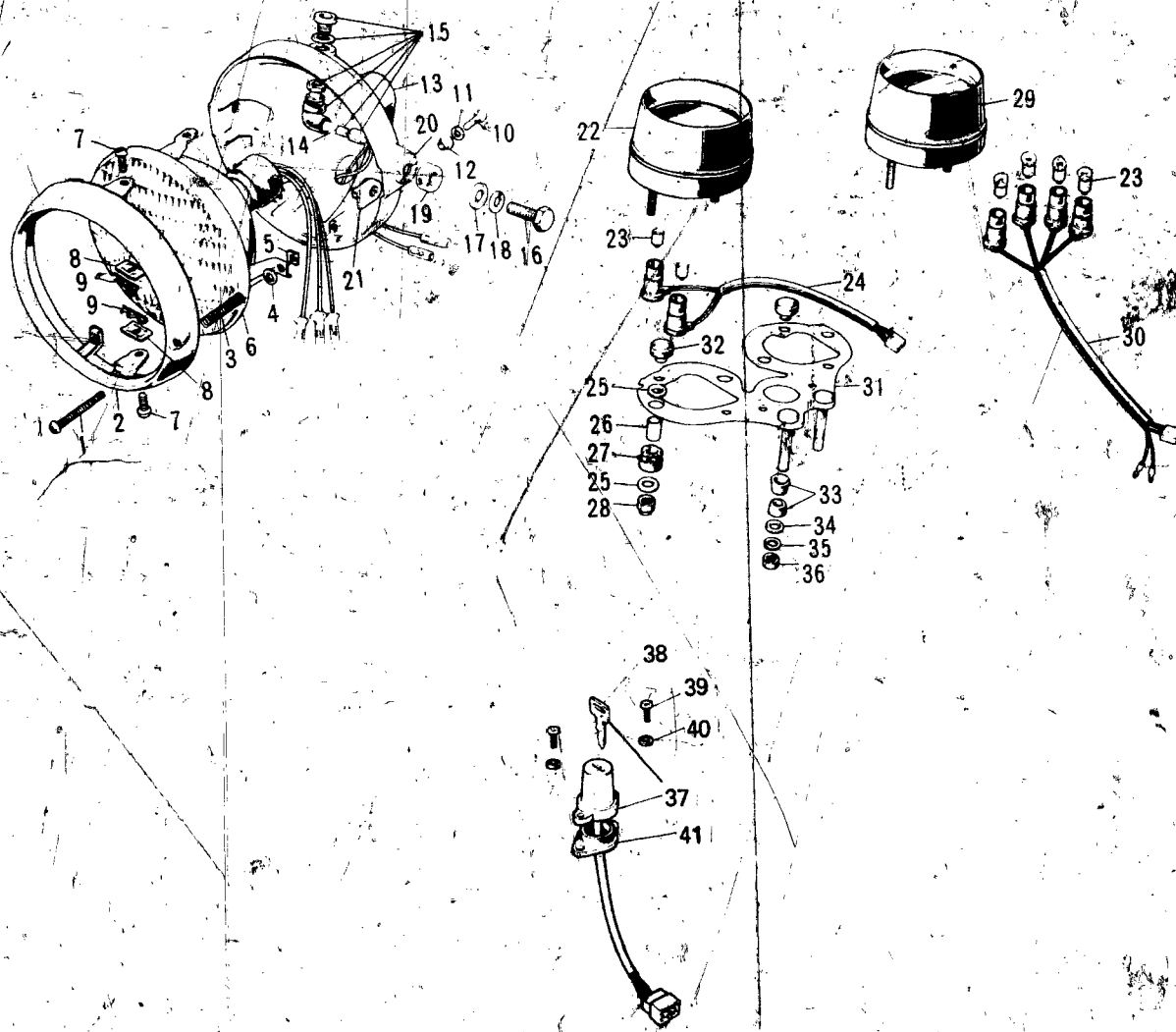

Ref. No.	Part No.	Part Name	Quantity	Remarks
1-9	23003-014	LAMP UNIT - head	1	
1	23019-021	SCREW-focus adjusting	1	
2	23006-025	RIM-head lamp	1	
3	23014-005	SPRING-focus adjusting	1	
4	23021-004	WASHER	1	
5	23020-016	NUT	1	
6	23007-030	LENS UNIT-head lamp	1	12V-35/25W
7	23019-018	SCREW-lens unit fitting	2	
8	23020-009	NUT-lens unit fitting	2	
9	23022-001	PIN-lens unit fitting	2	
10	92011-024	SCREW-pan head, 5 x 14	2	
11	461F0500	WASHER-spring, 5 m/m	2	
12	23021-010	WASHER, 5 m/m	2	
13	23005-032-10	BODY-head lamp	1	
14	92069-017	BULB, 12V-1.5W	1	
15	23016-006	LAMP ASSY-high beam indicator	1	
16	92007-024	BOLT-head lamp fitting	2	
17	411B1000	WASHER-plain, 10 m/m	2	
18	461F1000	WASHER-spring, 10 m/m	2	
19	92075-079	DAMPER RUBBER-head lamp	2	
20	23021-011	WASHER-head lamp fitting	2	
21	23020-017	NUT-head lamp fitting	2	
22-28	25005-050	SPEEDOMETER ASSY	1	
23	92069-018	BULB, 12V-3W	6	
24	25011-020	SOCKET ASSY-speedometer	1	
25	92022-194	WASHER-plain, 6 m/m	8	
26	92027-140	COLLAR-speedometer fitting	4	
27	92075-089	DAMPER RUBBER-speedometer fitting	4	
28	92015-009	NUT-cap, 6m/m	4	
23,25-30	25016-011	TACHOMETER ASSY	1	
30	25011-021	SOCKET ASSY-tachometer	1	
31	25008-014	BRACKET-speedometer	1	
32	92075-090	DAMPER RUBBER-meter	3	
33	92075-080	DAMPER RUBBER-meter bracket	4	
34	411B0800	WASHER-plain, 8 m/m	2	
35	461F0800	WASHER-spring, 8 m/m	2	
36	310B0800	NUT, 6 m/m	2	
37	27005-036	SWITCH ASSY-ignition	1	
38	27008-042-85	KEY SET, No 685	1	
	27008-042-86	KEY SET, No 686	1	
	27008-042-87	KEY SET, No 687	1	
	27008-042-88	KEY SET, No 688	1	
	27008-042-89	KEY SET, No 689	1	
	27008-042-01	KEY SET, No 701	1	
	27008-042-02	KEY SET, No 702	1	
	27008-042-03	KEY SET, No 703	1	
	27008-042-04	KEY SET, No 704	1	
	27008-042-05	KEY SET, No 705	1	
39	92011-022	SCREW-pan head, 6 m/m	2	
40	410B0800	WASHER-plain, 8 m/m	2	
41	92075-077	DAMPER RUBBER	1	

AIR CLEANER	B7
BRAKE, DISC	E5
BRAKE DISC, EQUIPMENT	C7
CABLES	F4
CARBURETOR	C2
CLUTCH	A7
COVERS, ENGINE	B5
COVERS, SIDE	E7
CRANKCASE	A5
CRANKSHAFT	A6
CYLINDER, CYLINDER HEAD	A4
ELECTRICAL, ENGINE	B6
ELECTRICAL, WIRING	G3
FENDERS	D7
FOOTREST	C6
FORK, FRONT, S2	D4
FORK, FRONT, S2-A	D5, D6
FRAME	C4
GEAR CHANGE MECHANISM	B3
HANDLEBAR	D2, D3
HEADLAMP, METERS, S2	F5
HEADLAMP, METERS, S2-A	F6
HUB, FRONT, S2	E4
HUB, FRONT, S2-A	E5
HUB, REAR	E3
KICKSTARTER	B4
MUFFLER	B7
OIL PUMP	C3
OPTIONAL PARTS	G4
PISTON, RINGS	A6
SEAT, DUAL, S2	F2
SEAT, DUAL, S2-A	F3
SWINGARM	G5
TAIL LAMP, S2	F7
TAIL LAMP, S2-A	G2
TANK, FUEL	E6
TANK, OIL	E7
TOOLS	G4
TRANSMISSION	B2
TURN SIGNAL, S2	F7
TURN SIGNAL, S2-A	G2
WHEELS	E2