

CRANKCASE

CONTENTS

Ref. No.	Part No.	Part Name	Quantity	Remarks
1-5	14001-049	CRANK CASE SET	1	
3	552A1014	DOWEL PIN, 10x14	4	
4	92042-016	DOWEL PIN, 6m/m	3	
5	92028-071	BUSHING-gear change pedal shaft	1	
6	92049-004	OIL SEAL, SB12205	1	
7	14043-013	RING-bearing setting	1	
8	14043-004	RING-bearing setting	2	
9	92087-001	PIEG-oil drain	1	
10	92065-011	GASKET-oil drain plug	1	
11	14015-001	RECEIVER-oil	1	
12	14015-003	RECEIVER-oil	1	
13	221E0616	SCREW-countersunk head, 6x16	1	
14	172G1050	STUD, 10x50	4	
15	172G1070	STUD, 10x70	2	
16	172G1080	STUD, 10x80	2	
17	172G08115	STUD, 8x115	12	
18	172G0622	STUD, 6x22	2	
19	172G0635	STUD, 6x35	3	
20	172G0645	STUD, 6x45	5	
21	172G0665	STUD, 6x65	3	
22	316B1000	NUT, 10m/m	8	
23	310B0400	NUT, 6m/m	13	
24	461F0400	WASHER-spring, 6m/m	13	
25	461F1000	WASHER-spring, 10m/m	8	
26	220B0610	SCREW-pan head, 6x10	1	
27	14069-003	BREATHER-crank case	1	
28	92059-061	PIPE-breather	1	

AIR CLEANER	B7
BRAKE, DISC	E5
BRAKE DISC, EQUIPMENT	C7
CABLES	F4
CARBURETOR	C2
CLUTCH	A7
COVERS, ENGINE	B5
COVERS, SIDE	E7
CRANKCASE	A5
CRANKSHAFT	A6
CYLINDER, CYLINDER HEAD	A4
ELECTRICAL, ENGINE	B6
ELECTRICAL, WIRING	G3
FENDERS	D7
FOOTREST	C6
FORK, FRONT, S2	D4
FORK, FRONT, S2-A	D5, D6
FRAME	C4
GEAR CHANGE MECHANISM	B3
HANDLEBAR	D2, D3
HEADLAMP, METERS, S2	F5
HEADLAMP, METERS, S2-A	F6
HUB, FRONT, S2	E4
HUB, FRONT, S2-A	E5
HUB, REAR	E3
KICKSTARTER	B4
MUFFLER	B7
OIL PUMP	C3
OPTIONAL PARTS	G4
PISTON, RINGS	A6
SEAT, DUAL, S2	F2
SEAT, DUAL, S2-A	F3
SWINGARM	C5
TAIL LAMP, S2	F7
TAIL LAMP, S2-A	G2
TANK, FUEL	E6
TANK, OIL	E7
TOOLS	G4
TRANSMISSION	B2
TURN SIGNAL, S2	F7
TURN SIGNAL, S2-A	G2
WHEELS	E2

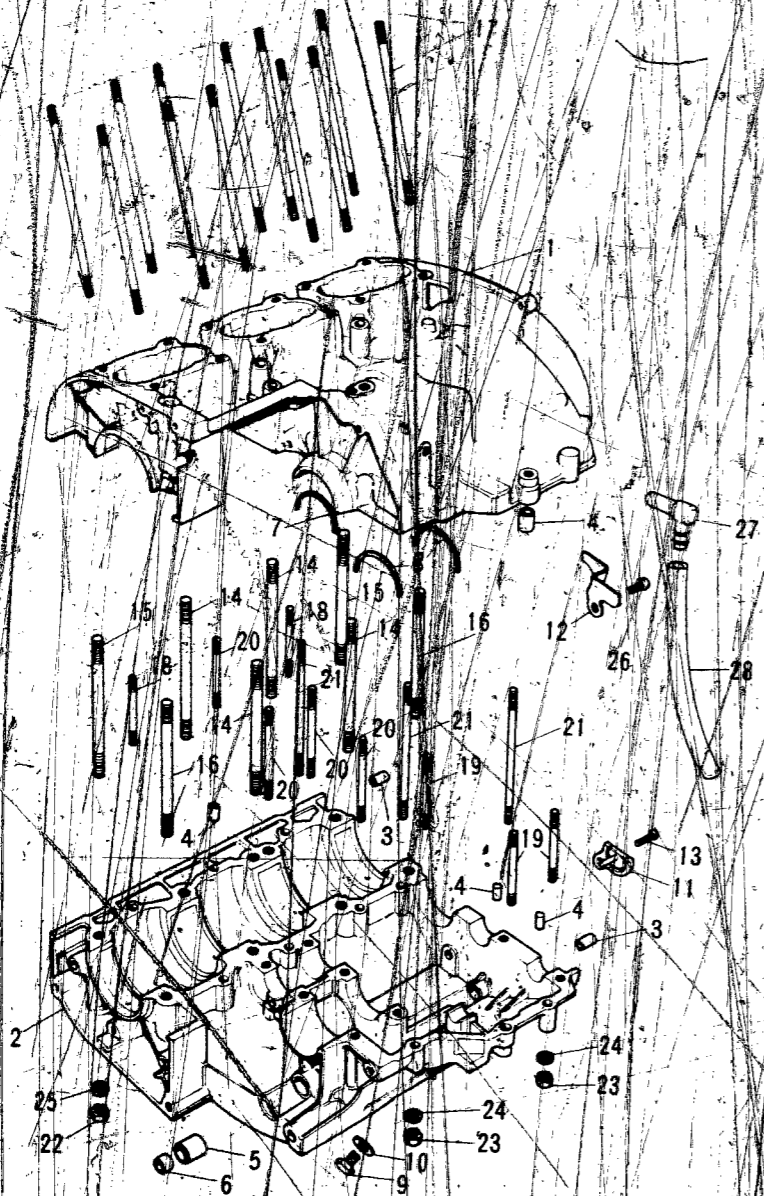

S2/S2-A

A5