

ENGINE COVERS

CONTENTS

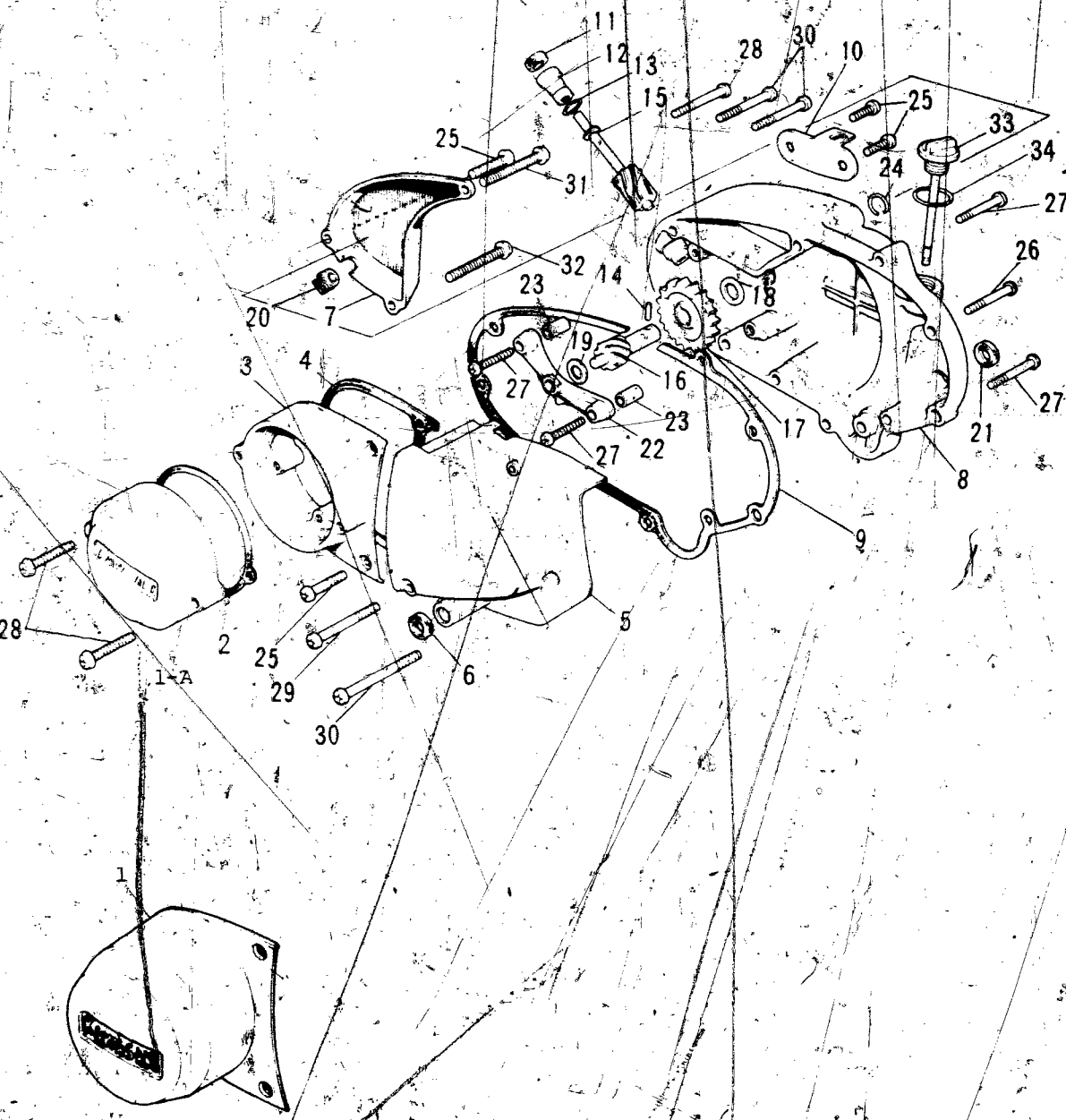

S2/S2-A

Ref. No	Part No.	Part Name	Quantity	Remarks
1	14031-047	CAP-contact breaker point Melamine Clear	1	
1-A	14027-016-80	CAP-contact breaker point Melamine Clear	1	E No. 11111 & above
2	14050-005	GASKET-point cap	1	
3	14031-052	COVER-L.H. engine	1	
	14031-052-36	COVER-L.H. engine Melamine Clear	1	S2-A
4	14045-012	GASKET-L.H. engine cover	1	
5	14026-008	COVER-front chain	1	
	14026-008-36	COVER-front chain Melamine Clear	1	S2-A
6	656G121805	OIL SEAL, VB12185	1	
7	14030-030	COVER-oil pump	1	
	14030-030-36	COVER-oil pump Melamine Clear	1	S2-A
8	14032-061	COVER-R.H. engine	1	
	14032-061-36	COVER-R.H. engine Melamine Clear	1	S2-A
9	14046-019	GASKET-R.H. engine cover	1	
10	14044-006	HOLDER-oil pump cable	1	
11	92054-004	OIL SEAL, SB12205	1	
12	92028-075	BUSHING-tachometer gear shaft	1	
13	92055-025	"O" RING	1	
14	92042-015	DOWEL PIN	1	
15	13226-005	SHAFT-tachometer gear	1	
16	13224-008	GEAR-tachometer	1	
17	16085-017	GEAR-oil pump	1	
18	92026-025	WASHER-thrust	1	
19	92026-026	WASHER-thrust	1	
20	14038-030	GROMMET-R.H. engine cover	1	
21	92049-002	OIL SEAL, SB16244	1	
22	14018-005	HOLDER-tachometer gear	1	
23	92042-007	DOWEL PIN	2	
24	92036-017	CIRCLIP	1	
25	220B0620	SCREW-pan head, 6x20	5	
26	220B0625	SCREW-pan head, 6x25	2	
27	220B0630	SCREW-pan head, 6x30	6	
28	220B0635	SCREW-pan head, 6x35	3	
29	220B0645	SCREW-pan head, 6x45	1	
30	220B0655	SCREW-pan head, 6x55	4	
31	220B0690	SCREW-pan head, 6x90	1	
32	220B06100	SCREW-pan head, 6x100	1	
33	220B06017	PLUG-oil filler	1	
34	670B2020	"O" RING, 20m/m	1	

B5

AIR CLEANER	B7
BRAKE, DISC	E5
BRAKE DISC, EQUIPMENT	C7
CABLES	F4
CARBURETOR	C2
CLUTCH	A7
COVERS, ENGINE	B5
COVERS, SIDE	E7
CRANKCASE	A5
CRANKSHAFT	A6
CYLINDER, CYLINDER HEAD	A4
ELECTRICAL, ENGINE	B6
ELECTRICAL, WIRING	G3
FENDERS	D7
FOOTREST	C6
FORK, FRONT, S2	D4
FORK, FRONT, S2-A	D5, D6
FRAME	C4
GEAR CHANGE MECHANISM	B3
HANDLEBAR	D2, D3
HEADLAMP, METERS, S2	F5
HEADLAMP, METERS, S2-A	F6
HUB, FRONT, S2	E4
HUB, FRONT, S2-A	E5
HUB, REAR	E3
KICKSTARTER	B4
MUFFLER	B7
OIL PUMP	C3
OPTIONAL PARTS	G4
PISTON, RINGS	A6
SEAT, DUAL, S2	F2
SEAT, DUAL, S2-A	F3
SWINGARM	C5
TAIL LAMP, S2	F7
TAIL LAMP, S2-A	G2
TANK, FUEL	E6
TANK, OIL	E7
TOOLS	G4
TRANSMISSION	B2
TURN SIGNAL, S2	F7
TURN SIGNAL, S2-A	G2
WHEELS	E2