

OIL PUMP

Ref. No.	Part No.	Part Name	Quantity	Remarks
* 1	16082-041	OIL PUMP ASSY	1	
2	92060-008	BOLT-banjo, L=17.5m/m	3	
3	92060-009	BOLT-banjo, L=24m/m	1	
4	92061-015	CONNECTOR-banjo	1	
5	92022-077	GASKET-oil pump	5	
5-A	92022-058	GASKET-oil pump	1	
6	16089-001	"V" RING-oil pump cam shaft	1	
7	16090-002	"O" RING-oil pump shaft	1	
8	16091-001	OIL SEAL-oil pump shaft	1	
9	16088-002	"O" RING-oil pump upper cap	1	
10	16090-003	"O" RING-oil pump lower cap	1	
11	16096-006	LEVER-oil pump cable(WHN EXH USE 16096-011)	1	
12	16096-011	LEVER-oil pump cable	1	
12	16094-002	GASKET-oil pump	1	
13	220B0514A	SCREW-pan head, 5x14	1	
14	220B0528A	SCREW-pan head, 5x28	1	
15	92022-037	WASHER-oil pump	2	
16	16134-012	PIPE ASSY-oil, L.H.	1	
17	16134-013	PIPE ASSY-oil, CENTER	1	
18	16134-014	PIPE ASSY-oil, R.H.	1	
19	92060-010-79	BOLT-banjo	3	
20	92065-023	GASKET-check valve	3	
21	92065-058	GASKET-check valve	3	

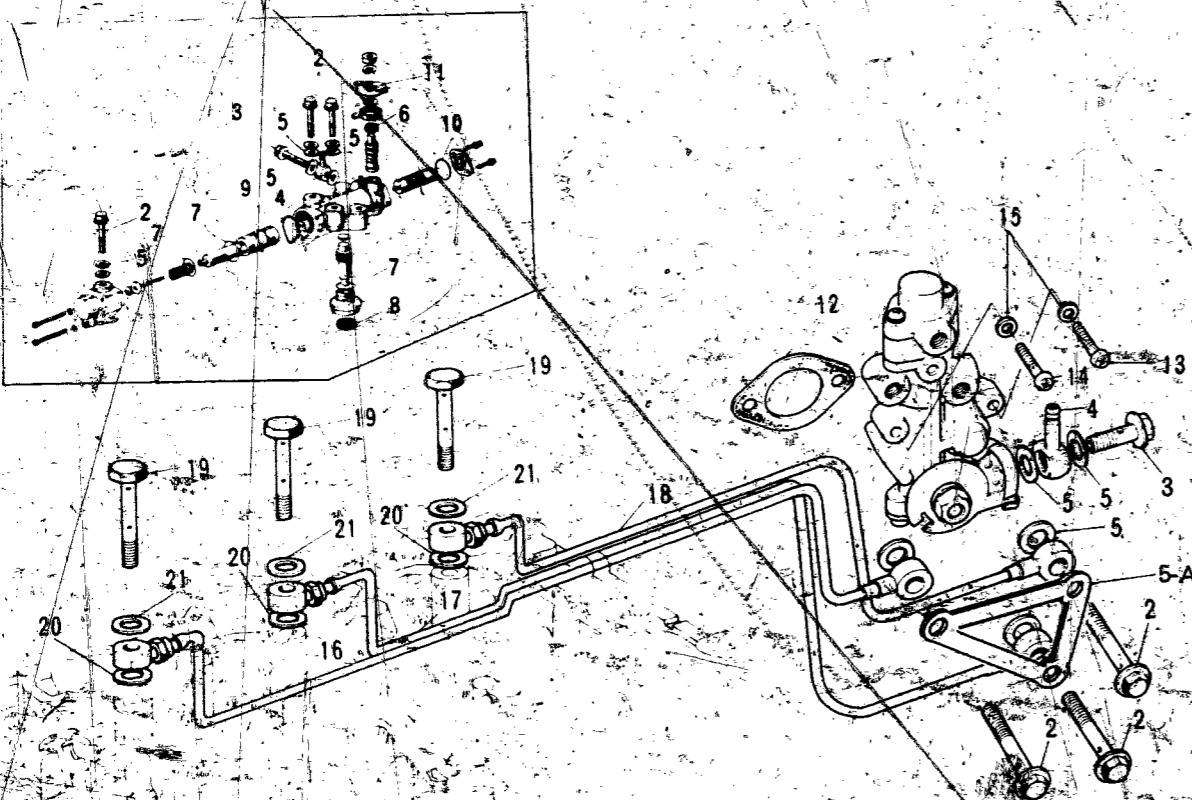

CONTENTS

AIR CLEANER	B7
BRAKE, DISC	E5
BRAKE DISC, EQUIPMENT	C7
CABLES	F4
CARBURETOR	C2
CLUTCH	A7
COVERS, ENGINE	B5
COVERS, SIDE	E7
CRANKCASE	A5
CRANKSHAFT	A6
CYLINDER, CYLINDER HEAD	A4
ELECTRICAL, ENGINE	B6
ELECTRICAL, WIRING	G3
FENDERS	D7
FOOTREST	G6
FORK, FRONT, S2	D4
FORK, FRONT, S2-A	D5, D6
FRAME	C4
GEAR CHANGE MECHANISM	B3
HANDLEBAR	D2, D3
HEADLAMP, METERS, S2	F5
HEADLAMP, METERS, S2-A	F6
HUB, FRONT, S2	E4
HUB, FRONT, S2-A	E5
HUB, REAR	E3
KICKSTARTER	B4
MUFFLER	B7
OIL PUMP	C3
OPTIONAL PARTS	G4
PISTON, RINGS	A6
SEAT, DUAL, S2	F2
SEAT, DUAL, S2-A	F3
SWINGARM	C5
TAIL LAMP, S2	F7
TAIL LAMP, S2-A	G2
TANK, FUEL	E6
TANK, OIL	E7
TOOLS	G4
TRANSMISSION	B2
TURN SIGNAL, S2	F7
TURN SIGNAL, S2-A	G2
WHEELS	E2