

# HANDLEBAR GRIPS

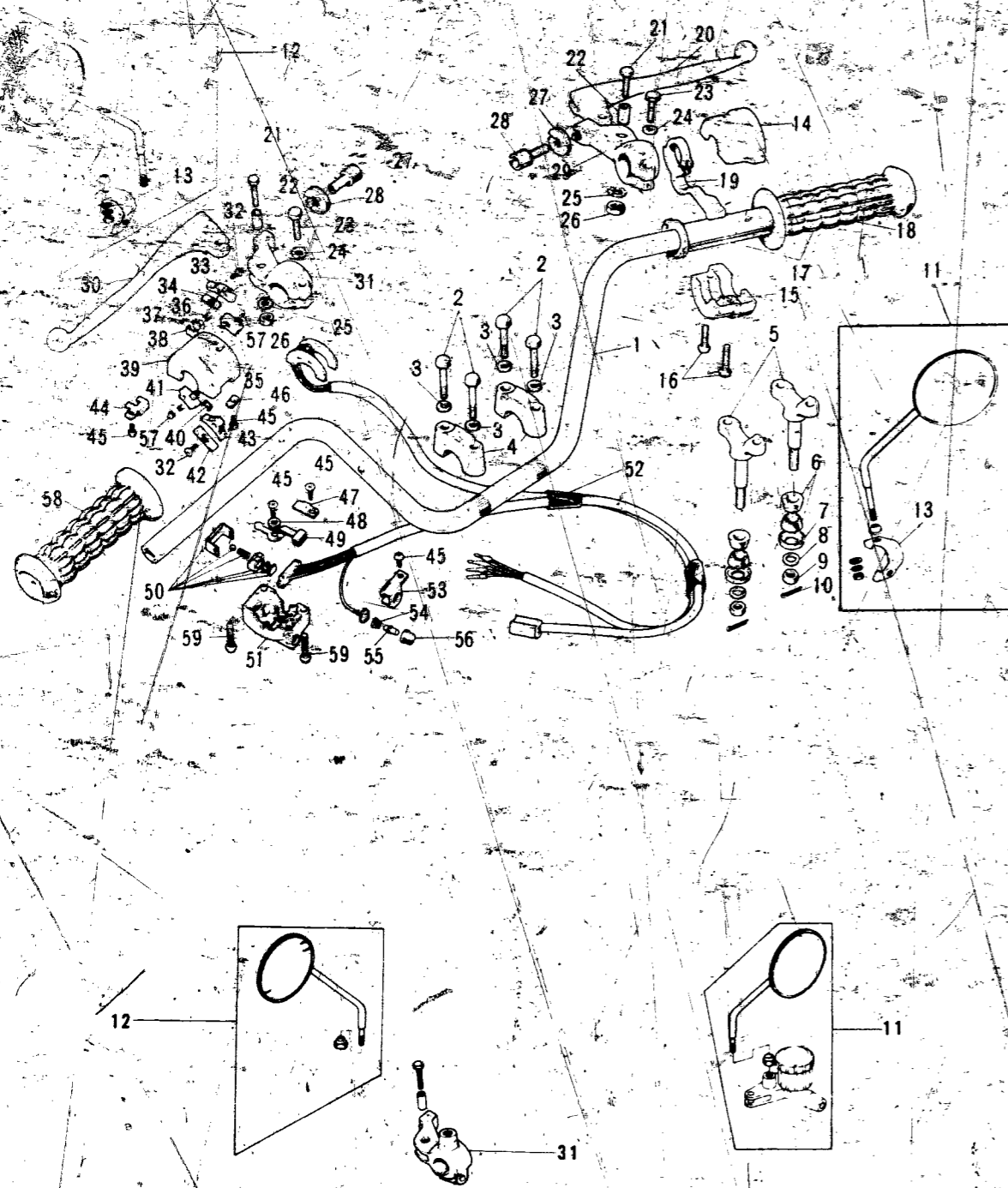

Ref. No.	Part No.	Part Name	Quantity	Remarks
21-28	46076-021	LEVER ASSY-clutch	1	
30-31	46076-027	LEVER ASSY-clutch	1	S2A
30	46092-005	LEVER-clutch	1	option
	46092-014	LEVER-clutch	1	S2A
	46092-015	LEVER-clutch ADC 5	1	
31	46094-010	HOLDER-clutch	1	
	46094-011-21	HOLDER-clutch lever <i>Flat-Black</i>	1	S2A
32-59	46091-005	CASE ASSY, L.H.	1	
32	221B0308A	SCREW-oval countersunk head, 3x8	2	
33	46044-008	KNOB-L.H. switch, B	1	
34	46031-006	SPRING-L.H. switch knob, B	1	
35	46089-005	SWITCH-L.H. case, A	1	
36	46031-007	SPRING-L.H. switch	2	
37	46079-005	CONTACT-L.H. switch	2	
38	46080-004	PLATE-L.H. switch contact, B	1	
39	46086-014	CASE-L.H. switch upper	1	
40	46080-003	PLATE-L.H. switch contact, A	1	
41	46089-006	SWITCH-L.H. case, B	1	
42	46031-003	SPRING-L.H. switch knob, A	1	
43	46044-005	KNOB-L.H. switch, A	1	
44	46085-018	HOLDER-L.H. switch upper, A	1	
45	220B0305A	SCREW-pan head, 3x5	5	
46	46085-019	HOLDER-L.H. switch upper, B	1	
47	46085-016	HOLDER-L.H. switch lower, A	1	
48	92095-010	WASHER-plain, 3m/m	1	
49	46044-007	KNOB-switch	1	
50	46089-007	SLIDE BLOCK ASSY-L.H. switch	1	
51	46077-016	CASE-L.H. switch lower	1	
52	46082-018	WIRING-HARNESS-L.H. switch	1	
53	46085-017	HOLDER-L.H. switch lower, B	1	
54	46031-005	SPRING-horn switch	1	
55	46079-003	CONTACT-horn switch	1	
56	46028-003	BUTTON-horn switch	1	
57	46079-004	INSURATOR-L.H. switch	1	
58	46075-017	RUBBER-L.H. grip	1	
59	220B0522A	SCREW-pan head, 5x22	2	

# CONTENTS

AIR CLEANER	B7
BRAKE, DISC	E5
BRAKE DISC, EQUIPMENT	C7
CABLES	F4
CARBURETOR	C2
CLUTCH	A7
COVERS, ENGINE	B5
COVERS, SIDE	E7
CRANKCASE	A5
CRANKSHAFT	A6
CYLINDER, CYLINDER HEAD	A4
ELECTRICAL, ENGINE	B6
ELECTRICAL, WIRING	G3
FENDERS	D7
FOOTREST	C6
FORK, FRONT, S2	D4
FORK, FRONT, S2-A	D5, D6
FRAME	C4
GEAR CHANGE MECHANISM	B3
HANDLEBAR	D2, D3
HEADLAMP, METERS, S2	F5
HEADLAMP, METERS, S2-A	F6
HUB, FRONT, S2	E4
HUB, FRONT, S2-A	E5
HUB, REAR	E3
KICKSTARTER	B4
MUFFLER	B7
OIL PUMP	C3
OPTIONAL PARTS	G4
PISTON, RINGS	A6
SEAT, DUAL, S2	F2
SEAT, DUAL, S2-A	F3
SWINGARM	C5
TAIL LAMP, S2	F7
TAIL LAMP, S2-A	G2
TANK, FUEL	E6
TANK, OIL	E7
TOOLS	G4
TRANSMISSION	B2
TURN SIGNAL, S2	F7
TURN SIGNAL, S2-A	G2
WHEELS	E2

S2/S2-A

D3