

# DUAL SEAT, SEAT BACKREST S2

# CONTENTS

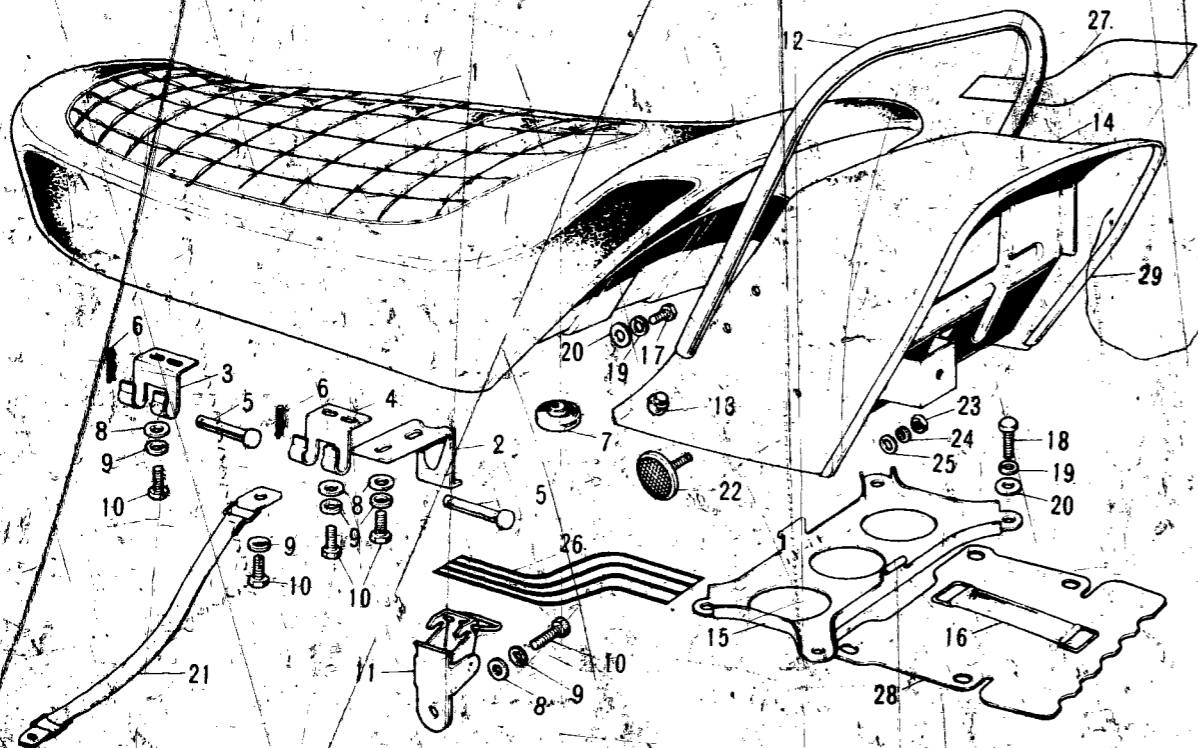

Ref. No.	Part No.	Part Name	Quantity	Remarks
1	53001-070	SEAT ASSY-dual	1	
2	53008-011	HOOK-seat	1	
3	53009-017	HINGE-seat	1	
4	53009-021	HINGE-seat	1	
5	53011-002	PIN-seat pivot	2	
6	92041-003	COTTER PIN	2	
7	92045-033	DAMPER RUBBER-dual seat	5	
8	411B0600	WASHER-plain, 6m/m	8	
9	461F0600	WASHER-spring, 6m/m	9	
10	110B0614	BOLT-hex head, 6x14	8	
	116B0614	BOLT-hex head, 6x14	ALT	
11	53045-001	HOOK ASSY-seat	1	
12	53042-004	GRIP-seat	1	
13	32112-004	PLUG-seat grip	2	
14	53043-001-68	BACKREST-seat, P/C red (whn exh use 53043-001-84)		
	53043-001-84	BACKREST-seat, P/C red		
	53043-001-66	BACKREST-seat, P/C white (whn exh use 53043-001-85)		
	53043-001-85	BACKREST-seat, P/C white		
15	32098-015	CASE-tool	1	
16	92072-012	BAND-tool	1	
17	110B0812	BOLT-hex head, 8x12	4	
	116B0812	BOLT-hex head, 8x12	ALT	
18	110B0820	BOLT-hex head, 8x20	4	
	116B0820	BOLT-hex head, 8x20	ALT	
19	461F0800	WASHER-plain, 8m/m	8	
20	411B0800	WASHER-plain, 8m/m	4	
21	92072-027	BAND-seat stopper WHN EXH USE 92072-038	(1)	
	92072-038	BAND-seat stopper	1	
22	28001-009	REFLECTOR-reflex, rear	2	
23	310B0500A	NUT, 5m/m	2	
24	461F0500	WASHER-spring, 5m/m	2	
25	411B0500	WASHER-plain, 5m/m	2	
26	56027-050	EMBLEM-L.H. seat backrest	1	
27	56027-052	EMBLEM-R.H. seat backrest	1	
28	53046-002	PLATE-dust	1	
29	53044-001	MOULDING-seat backrest	1	

AIR CLEANER	B7
BRAKE DISC	E5
BRAKE DISC, EQUIPMENT	C7
CABLES	F4
CARBURETOR	C2
CLUTCH	A7
COVERS, ENGINE	B5
COVERS, SIDE	E7
CRANKCASE	A5
CRANKSHAFT	A6
CYLINDER, CYLINDER HEAD	A4
ELECTRICAL, ENGINE	B6
ELECTRICAL, WIRING	G3
FENDERS	D7
FOOTREST	C6
FORK, FRONT, S2	D4
FORK, FRONT, S2-A	D5, D6
FRAME	C4
GEAR CHANGE MECHANISM	B3
HANDLEBAR	D2, D3
HEADLAMP, METERS, S2	F5
HEADLAMP, METERS, S2-A	F6
HUB, FRONT, S2	E4
HUB, FRONT, S2-A	E5
HUB, REAR	E3
KICKSTARTER	B4
MUFFLER	B7
OIL PUMP	C3
OPTIONAL PARTS	G4
PISTON, RINGS	A6
SEAT, DUAL, S2	F2
SEAT, DUAL, S2-A	F3
SWINGARM	C5
TAIL LAMP, S2	F7
TAIL LAMP, S2-A	G2
TANK, FUEL	E6
TANK, OIL	E7
TOOLS	G4
TRANSMISSION	B2
TURN SIGNAL, S2	F7
TURN SIGNAL, S2-A	G2
WHEELS	E2