

S2

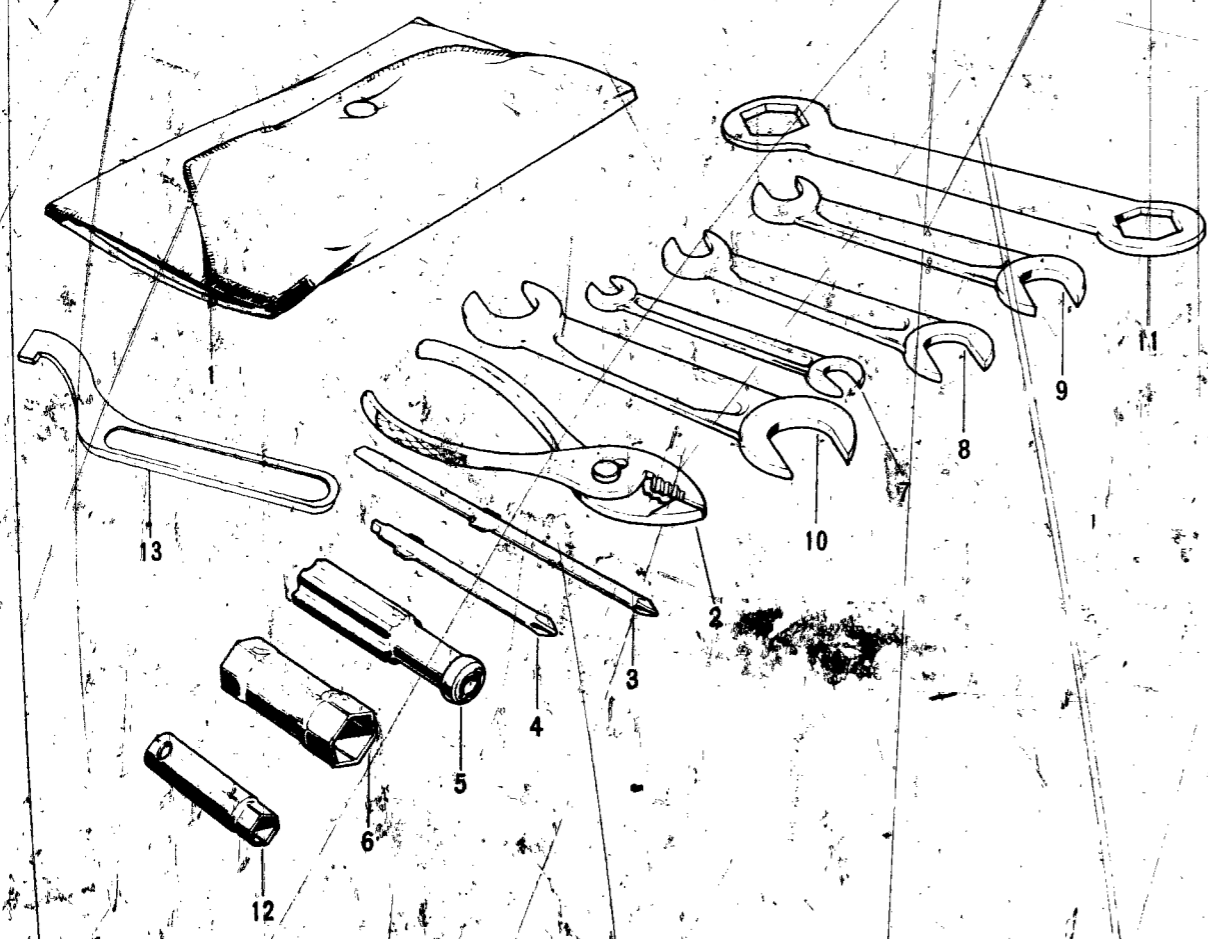

TOOLS

Ref. No.	Part No.	Part Name	Quantity	Remarks
1~13	56007-024	TOOL KIT	1	
1	56008-003	BAG-tool	1	
2	92112-001	PLIERS, 135m/m	1	
3	92107-003	DRIVER-No, 2 phillips & slot screw	1	
4	92107-005	DRIVER-No, 3 phillips screw	1	
5	92106-002	GRIP-screw driver	1	
6	92110-008	WRENCH-box, 17x21	1	
7	960B1012	WRENCH-open end, 10x12	1	
8	960B1013	WRENCH-open end, 10x13	1	
9	960B1417	WRENCH-open end, 14x17	1	
10	960B1921	WRENCH-open end, 19x21	1	
11	92109-002	WRENCH-box, 24x32	1	
12	92110-007	WRENCH-box, 10m/m	1	
13	92108-005	ADJUSTER-rear shock absorber	1	

CONTENTS

AIR CLEANER	B7
BRAKE, DISC	E5
BRAKE DISC, EQUIPMENT	C7
CABLES	F4
CARBURETOR	C2
CLUTCH	A7
COVERS, ENGINE	B5
COVERS, SIDE	E7
CRANKCASE	A5
CRANKSHAFT	A6
CYLINDER, CYLINDER HEAD	A4
ELECTRICAL, ENGINE	B6
ELECTRICAL, WIRING	G3
FENDERS	D7
FOOTREST	C6
FORK, FRONT, S2	D4
FORK, FRONT, S2-A	D5, D6
FRAME	C4
GEAR CHANGE MECHANISM	B3
HANDLEBAR	D2, D3
HEADLAMP, METERS, S2	F5
HEADLAMP, METERS, S2-A	F6
HUB, FRONT, S2	E4
HUB, FRONT, S2-A	E5
HUB, REAR	E3
KICKSTARTER	B4
MUFFLER	B7
OIL PUMP	C3
OPTIONAL PARTS	G4
PISTON, RINGS	A6
SEAT, DUAL, S2	F2
SEAT, DUAL, S2-A	F3
SWINGARM	C5
TAIL LAMP, S2	F7
TAIL LAMP, S2-A	G2
TANK, FUEL	E6
TANK, OIL	E7
TOOLS	G4
TRANSMISSION	B2
TURN SIGNAL, S2	F7
TURN SIGNAL, S2-A	G2
WHEELS	E2

OPTIONAL PARTS

Ref. No.	Part No.	Part Name	Quantity	Remarks
1	35022-062	FENDER-rear	1	
2	110B0618	BOLT-hex head, 6x18	2	
	116B0618	BOLT-hex head, 6x18	ALT	
3	461F0600	WASHER-spring, 6m/m	4	
4	92022-165	WASHER-plain	2	
5	411B0600	WASHER-plain, 6m/m	2	
6	310B0600	NUT, 6m/m	2	
7	35025-022	BRACKET-rear fender	1	
8	92075-051	DAMPER RUBBER	2	
9	92027-105	COLLAR	2	
10	220E0612	SCREW-pan head, 6x12	2	
11	220E0618	SCREW-pan head, 6x18	2	

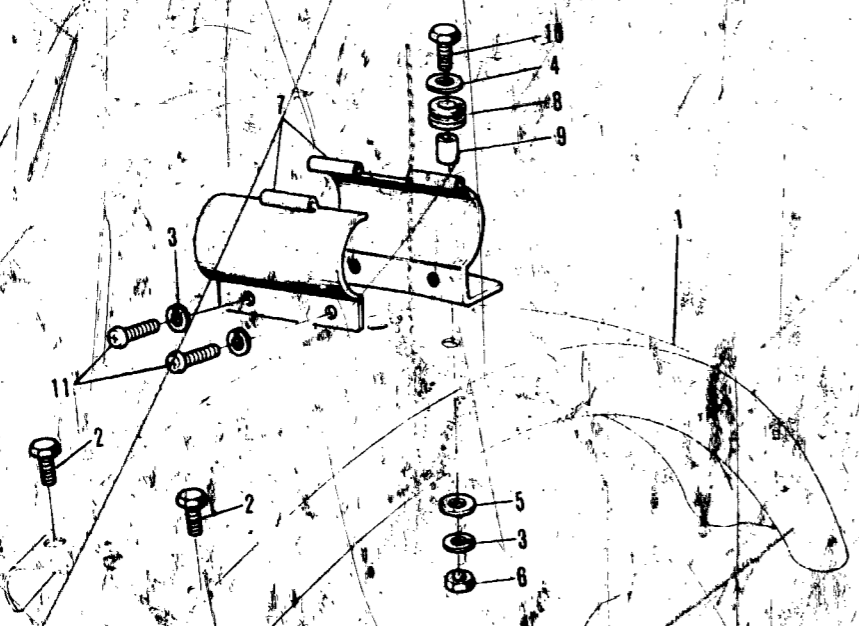

S2/S2-A

G4